



# morton.

**SYDNEY** 2601/148 Elizabeth Street

 2  2  1

Delightfully positioned to capture the midday and afternoon sun, this smart 84sqm two-bedroom apartment with parking is equally desirable as a convenient city residence or a shrewd investment.

Located on level 26 of the highly sought-after Hyde Park Towers, famous for its resort-style facilities and concierge, the apartment offers secure intercom access and is just moments from Hyde Park, Central Station, Chinatown, Pitt Street Mall, QVB and Martin Place.

Features include:

- Ducted air conditioning throughout
- Full range of resort-style facilities, including indoor pool, spa, steam room and fully equipped gymnasium
- Large lift foyer with video security, intercom and 24-hour concierge
- Bright, open-plan kitchen with gas cooktop and dishwasher

[morton.com.au](http://morton.com.au)

### View

As advertised or by appointment

### Agent

**Morton RE**

 [info@morton.com.au](mailto:info@morton.com.au)

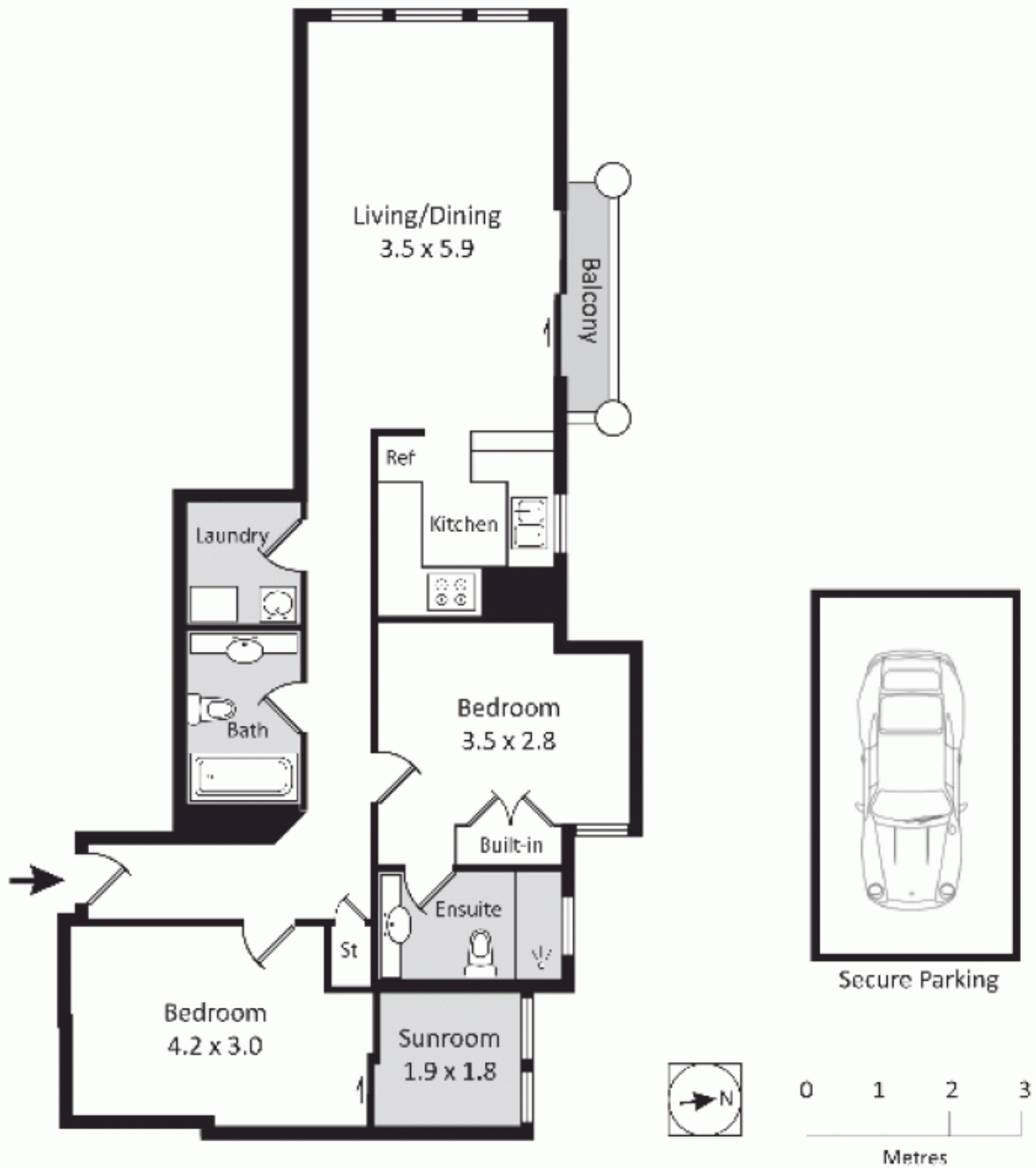

## Apartment 2601, 148 Elizabeth Street, Sydney

WILSON *up.* PROPERTY  
AGENTS

The information above is provided in good faith and has been provided to us from a variety of sources. We have not verified whether the information is accurate and do not have any belief one way or the other in its accuracy. We do not accept any responsibility to any person for its accuracy and do no more than pass it on. All interested parties should rely on their own inquiries in order to determine whether or not this information is in fact accurate.