



**morton.**

**SYDNEY** 2604/187 Liverpool Street

 2  2  1

This very rare high floor 126sqm two bedroom apartment is positioned on Level 26 of The Connaught and offers stunning North facing Hyde Park, Sydney Harbour and City Skyline views.

The open plan living and dining area leads out onto the large covered entertaining balcony with views from the Heads to the Opera House and to the Blue Mountains.

A good sized kitchen with servery bench has been recently updated with Caesar stone benchtops, double door fridge, new cupboard doors and stainless steel appliances.

The master bedroom provides marble ensuite and walk in robe, the second bedroom includes built-ins with access to a second marble family bathroom and laundry facilities. Both bedrooms have views and direct access to the balcony.

Additional features include secure parking space, reverse cycle air conditioning, security intercom, 24hr concierge,

**View**

As advertised or by appointment

**Agent**

**Morton RE**

 [info@morton.com.au](tel:)

**morton.com.au**



# 2604/187 Liverpool Street, Sydney

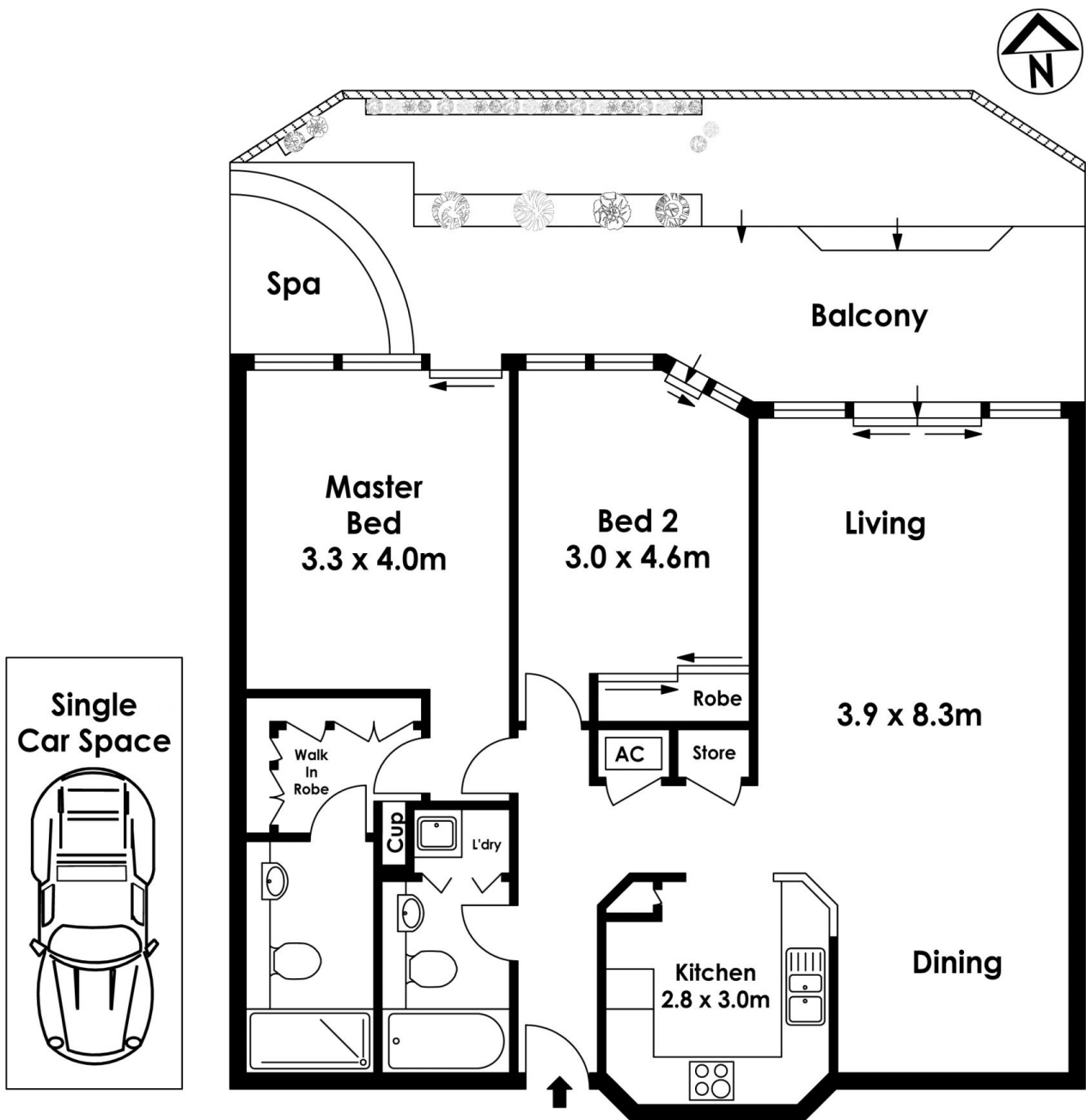

The information above is provided in good faith and has been provided to us from a variety of sources. We have not verified whether the information is accurate and do not have any belief one way or other in its accuracy. We do not accept any responsibility to any person for its accuracy and do no more than pass it on. All interested parties should rely on their own inquiries in order to determine whether or not this information is in fact accurate.