



morton.

ALEXANDRIA 25/240-270 Lawrence Street

 2  1  1

This sensational 97sqm two bedroom apartment with lock-up garage is situated in 'St Lawrence Apartments', a building popular for its quiet cul-de-sac position and wide tree-lined street, in one of Alexandria's most sought after locations.

Featuring a large, highly desirable wrap-around courtyard with direct street access, the freshly painted designer apartment comes with new carpets and wooden floors.

The open plan living/dining area is perfect for entertaining with a big kitchen comprising of granite bench tops, gas cooking and sleek breakfast bar for four people.

Both bedrooms accommodate built-in robes and the generous dual access bathroom offers ensuite facilities to the master bedroom. Completing the package is a separate internal laundry.

The 'St Lawrence Apartments' is a small, low rise security building in one of the inner-city's most sought after streets.

View

As advertised or by appointment

Agent

Morton RE

 info@morton.com.au

morton.com.au

25/240 - 270 Lawrence Street, Alexandria

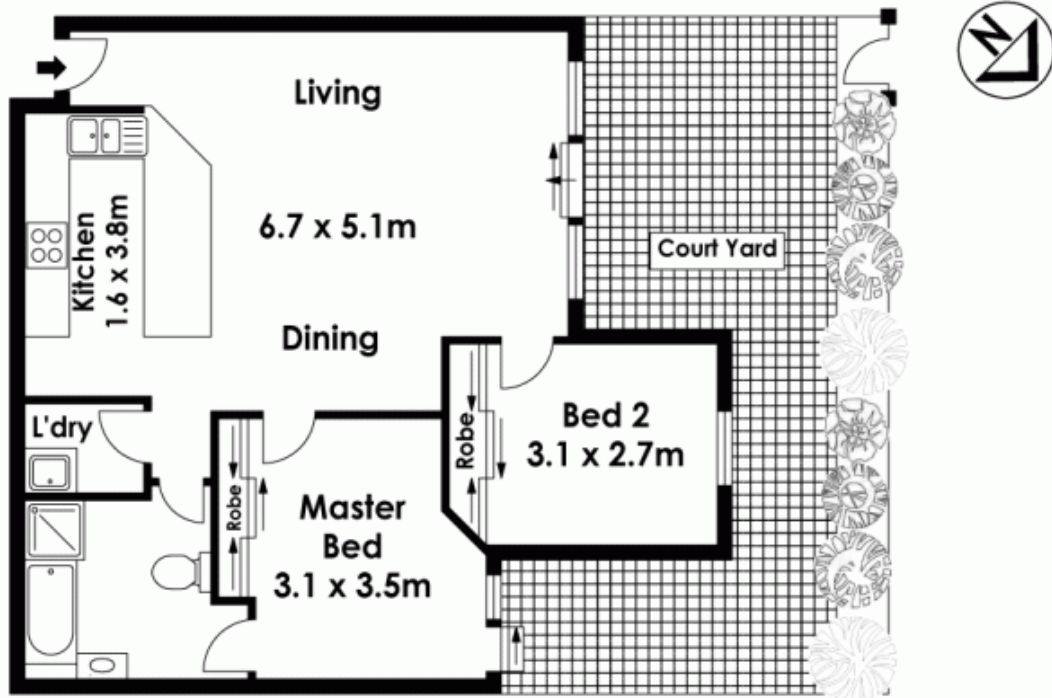

**Single
Lock Up
Garage**

The information above is provided in good faith and has been provide to us from a variety of sources. We have not verified whe accurate and do not have any belief one way or other in its accuracy. We do not accept any responsibility to any person for it pass it on. All interested parties should rely on their own inquiries in order to determine whether or not this information is

Floor Plan by www.squaremeter.com.au