



morton.

SYDNEY 423/27 Park Street

1 1 1

This un-renovated one bedroom apartment, located on the 42nd floor of the sought after Park Regis building, is a very rare find!

Featuring a panoramic North/East aspect over Hyde Park, The Domain, Sydney Harbour & the City lights, this is a view normally reserved for luxury penthouse apartments.

Residents of this iconic security building enjoy access to a roof top pool, sun deck, laundry and table tennis area.

Ripe for a renovation or quick make-over this property represents an amazing opportunity for those wanting to create their own mark on a city apartment with views & parking.

Park Regis is located next to Hyde Park, QVB & Town Hall at 27 Park Street, providing easy access to shops, cafes, restaurants and transport.

Currently tenanted, this fabulous city apartment will be a hit

View

As advertised or by appointment

Agent

Morton RE

info@morton.com.au

morton.com.au

423 / 27 Park Street, Sydney

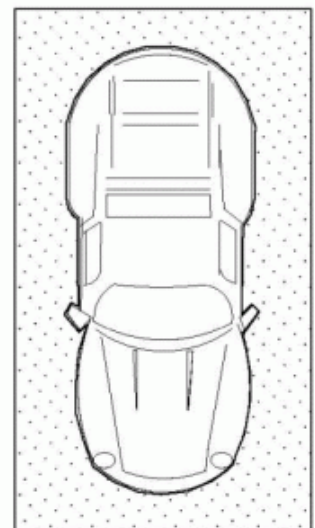
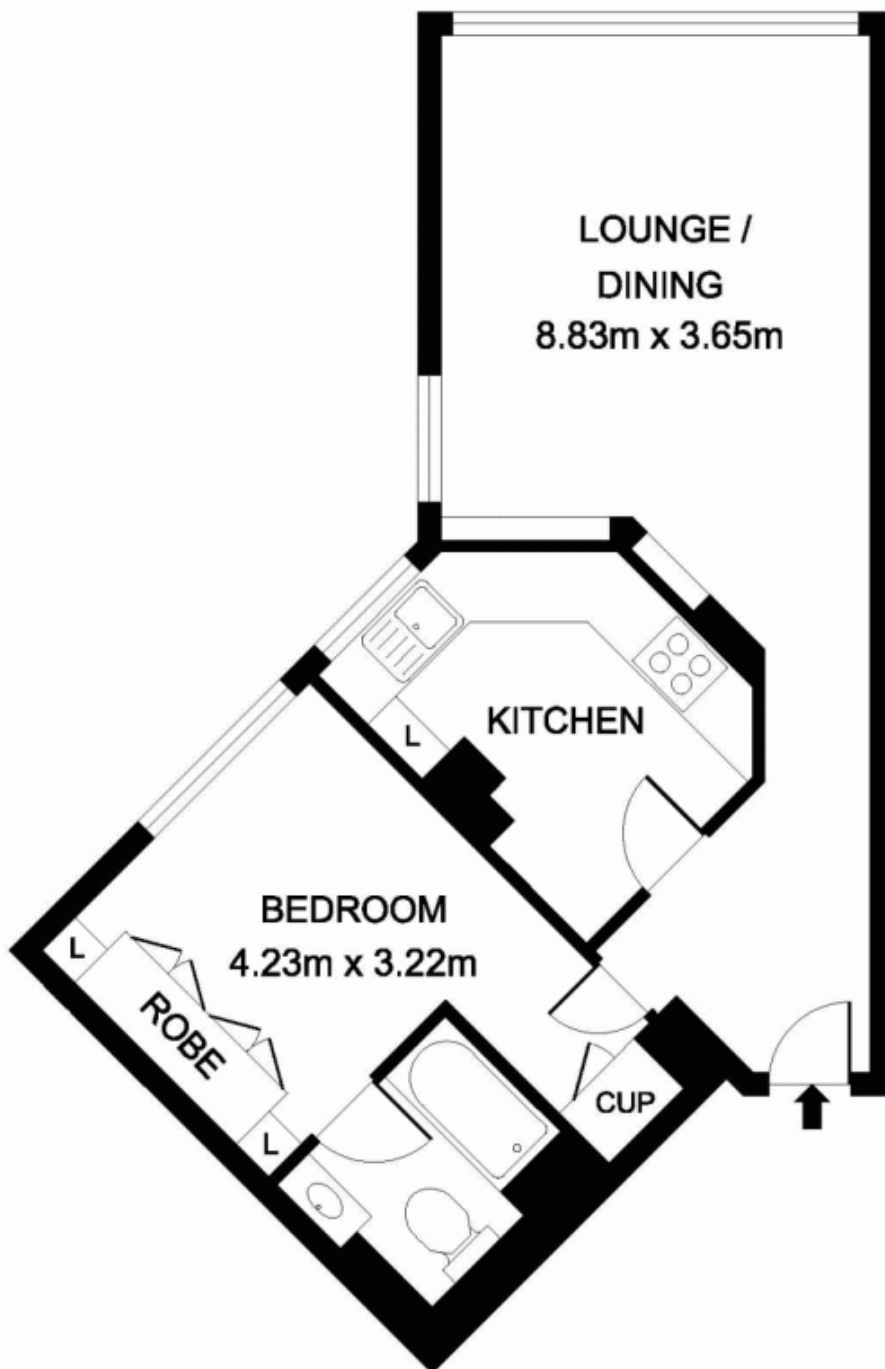

SINGLE
CAR SPACE