

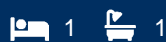

morton.

POTTS POINT 205/15 Bayswater Road



This immaculate, contemporary apartment is located on the 2nd floor of 'The Hampton' residences. A highly sought after development positioned amongst Potts Point's cosmopolitan culture.

Parisian- styled interiors and Art Deco accents are featured in this 89 sqm apartment with ambient light filled rooms, bay windows, high period ceilings and an outdoor balcony.

View

As advertised or by appointment

Agent

Sarah Fowell



sarah@morton.com.au

morton.com.au

205/15 Bayswater Road, Potts Point

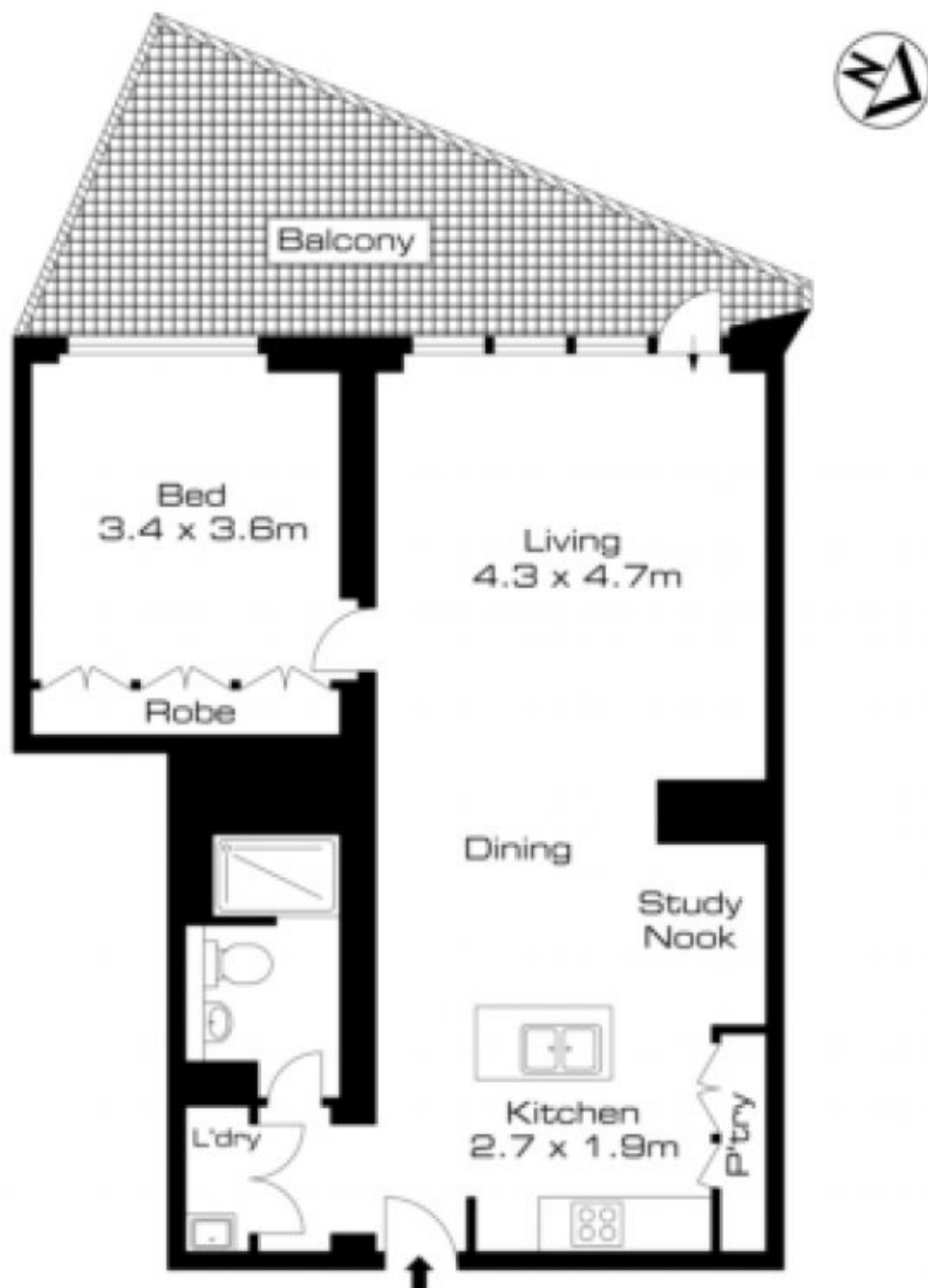

The information above is provided in good faith and has been provide to us from a variety of sources. We have not verified whether the information is accurate and do not have any belief one way or other in its accuracy. We do not accept any responsibility to any person for its accuracy and do no more than pass it on. All interested parties should rely on their own inquiries in order to determine whether or not this information is in fact accurate.