



morton.

SYDNEY 1109/8 Park Lane

 1  1

Offering an unrivalled urban village lifestyle in the newly created Central Park, the Park Lane residences sculpt together peaceful park living and vibrant conveniences with inspiring architecture and eco friendly innovation.

Attractive to investors with a modern mind-set this NE facing 11th floor apartment is the perfect inner city dwelling with spectacular city views. Clean lines, beautifully finished interiors and forward thinking design maximise on 47sqm of unique living space close to the education and artistic hub of Sydney.

Residents can enjoy access to impressive amenities. Unwind at the gym or on the pool level above the city skyline. Take a leisurely walk down to the central parklands or visit the Living Mall next door, with 4 levels of entertainment and shopping. Here is your chance to join an elite creative community and be part of the most unique development Sydney has ever seen.

Features include:

morton.com.au

View

As advertised or by appointment

Agent

Sarah Fowell



 sarah@morton.com.au

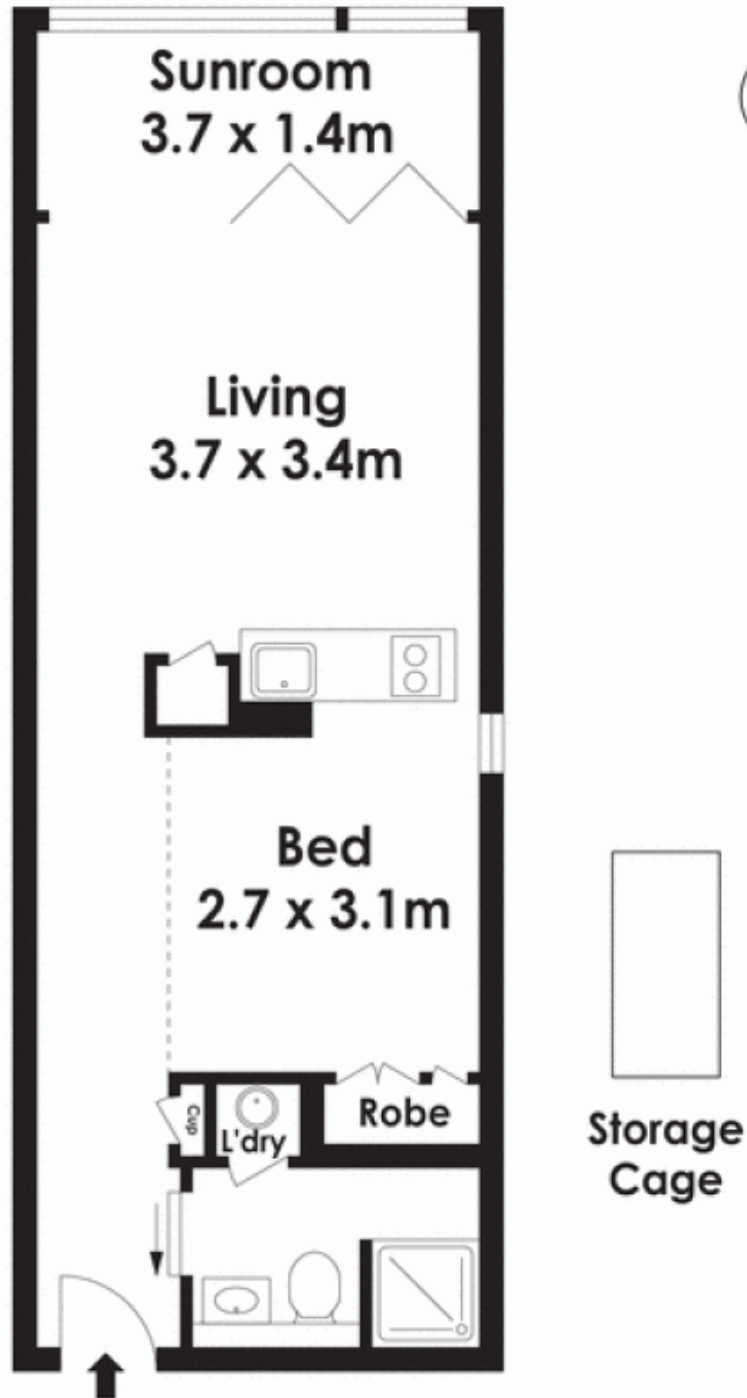

The information above is provided in good faith and has been provide to us from a variety of sources. We have not verified whether the information is accurate and do not have any belief one way or other in its accuracy. We do not accept any responsibility to any person for its accuracy and do no more than pass it on. All interested parties should rely on their own inquiries in order to determine whether or not this information is in fact accurate.