



# morton.

**SYDNEY** 603/45 Shelley Street

 1  1  1

Peacefully situated on level six, this unique 66sqm apartment offers an ideal opportunity for the professional wishing to reside or invest in an urban location within walking distance to the CBD. This modern apartment has a south westerly aspect with an expansive balcony which spans the entire length of the apartment, making the most of the lovely views over Darling Harbour.

- City living in the heart of Darling Harbour
- Large open plan living leading onto balcony with water glimpses
- Stylish open plan kitchen with island bench and gas stove
- Generous bedroom with build-in wardrobes and balcony access
- Luxurious mosaic bathroom with hideaway laundry
- Separate study, A/C, intercom, secure lift access and parking
- Ideal investment or the perfect city pad

### View

As advertised or by appointment

### Agent

**Ettiene West**

 0410 593 749

 [ettiene@morton.com.au](mailto:ettiene@morton.com.au)

[morton.com.au](http://morton.com.au)

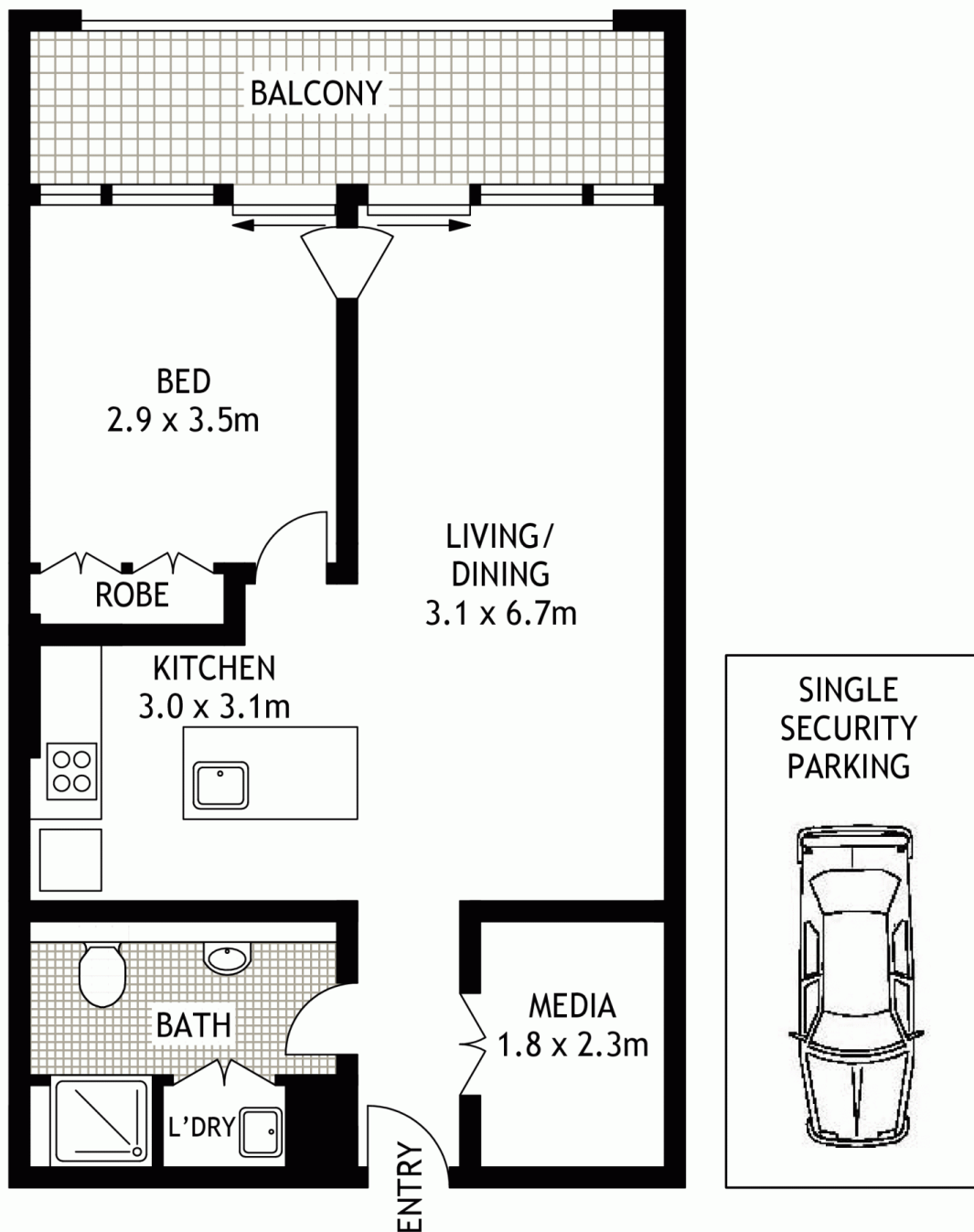

FOURTH FLOOR



603/45 SHELLEY STREET

SYDNEY

SCAPE Floor Planing Disclaimer: This floor plan is conceptual only. it is provided for illustrative purposes only and should not be relied upon. We make no guarantees to the correctness of this plan. All interested parties should make and rely on their own enquiries in determining the accuracy of the information contained in this floor plan.