



morton.

RANDWICK NORTH 20 Burton Street

3 2 1

Nestled in a tranquil tree-lined street is this north facing semi-detached home, filled with warmth and charm. Spread over two levels and well proportioned throughout, this property offers superb inner city living. An idyllic lifestyle, set in a highly sought-after location just minutes to Centennial Park and Randwick Junction.

- Living room with polished timber floors and feature fireplace
- Country style kitchen/dining with island bench
- Downstairs bathroom and laundry
- North facing courtyard, deck & storage
- Large second bedroom with fireplace
- Third bedroom with storage cupboard
- North facing oversized master bedroom with balcony access
- Tiled main bathroom with claw bath, 10sqm storage cupboard
- Land size 208sqm, huge lock up garage (29sqm) with storage
- Quiet and peaceful location
- Close to parks, schools, Tafe, UNSW, hospitals and shops

View

As advertised or by appointment

Agent

Ettiene West

0410 593 749

ettiene@morton.com.au

morton.com.au

20 Burton St, RANDWICK

SCALE 



* note
all measurements are approximate only.
Plan is provided only as an indication of layout.

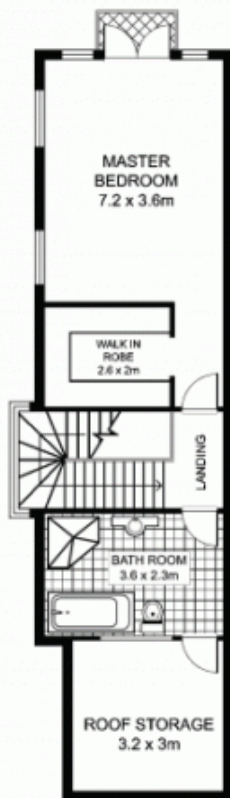

FIRST FLOOR

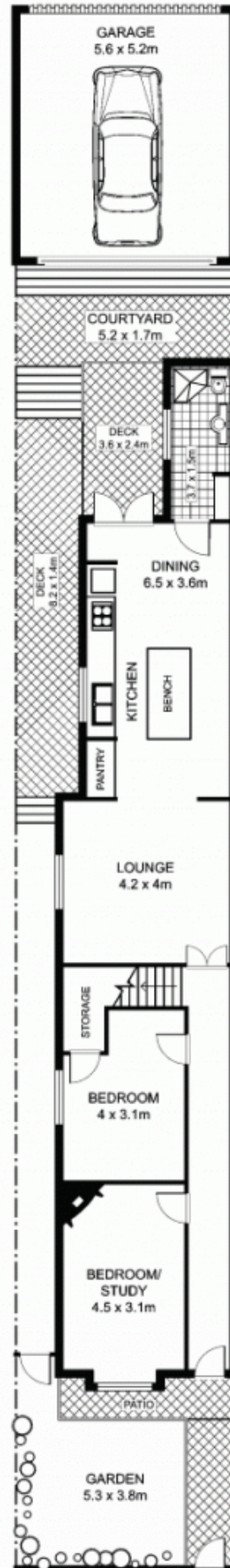

GROUND FLOOR