



morton.

WOOLLOOMOOLOO 125/88 Dowling Street

1 1 1

Set in the heart of Woolloomooloo a stones throw from the Wharf, this massive 64sqm studio apartment is positioned in a quiet cul-de-sac and comes with secure parking.

- Views over terrace rooftops & the city skyline are framed by floor-to-ceiling glass windows & doors, which open to a sunlit balcony

- Minutes to the CBD, Potts Point & Darlinghurst as well as a wide selection of cafes & eateries at your door

View

As advertised or by appointment

Agent

Sarah Fowell

📞 sarah@morton.com.au

morton.com.au

125/ 88 Dowling Street, Woolloomooloo

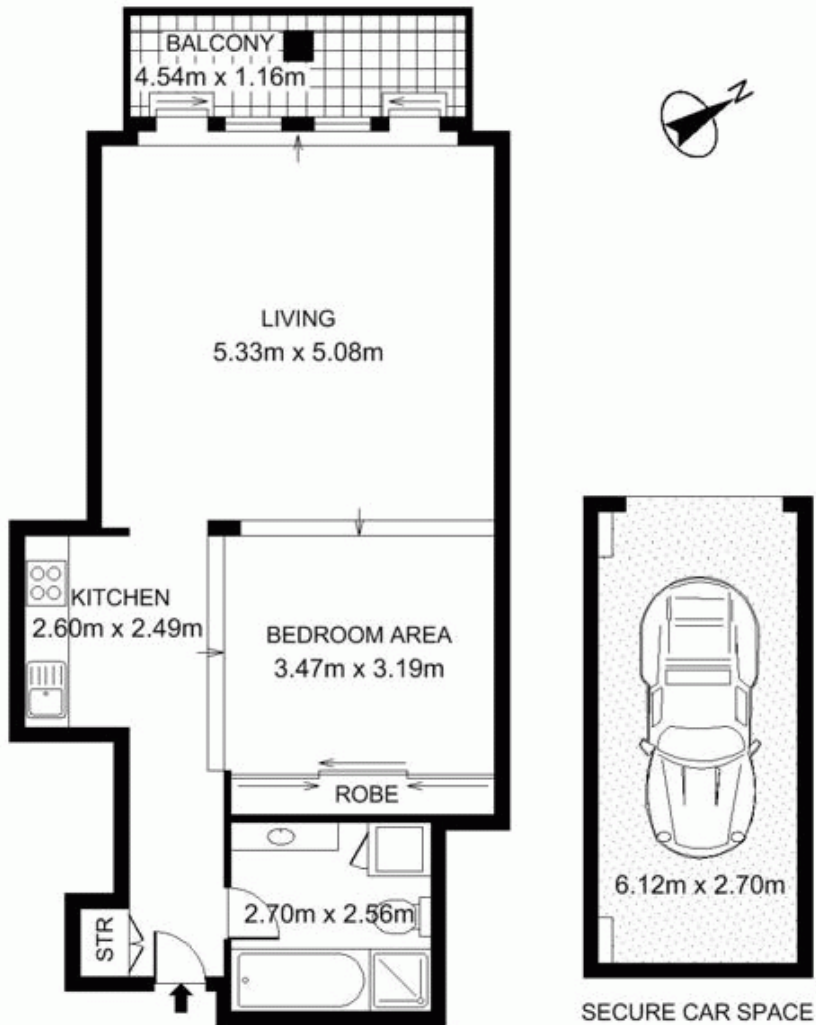

PARKING FLOOR AREA 17 SQM
INTERNAL FLOOR AREA 64 SQM

The information above is provided in good faith and has been provided to us from a variety of sources. We have not verified whether the information is accurate and do not have any belief one way or other in its accuracy. We do not accept any responsibility to any person for its accuracy and do no more than pass it on. All interested parties should rely on their own inquiries in order to determine whether or not this information is in fact accurate.
Floor plan by www.squaremeter.com.au