



morton.

Zetland 637/2B Defries Avenue

 1  1  1

Designed for stylish and convenient living this beautifully presented one bedroom apartment is located within Victoria Park's coveted East Village, enjoying immediate access to a unique sky park and vibrant retail and dining precinct below. Recently built in 2014 by developers PAYCE and designed by Turner + Associates, the apartment blends high quality finishes with functional spaces and is perfect for tenacious investors or owner occupiers.

- 53sqm floor plan highlighted by sleek interior styling
- Peaceful all-weather balcony with metropolitan views
- Large study area/home office
- Open plan lounge and dining with polished tiled floors
- Integrated kitchen with granite bench tops and stainless steel appliances
- Spacious double bedroom with walk-in robe and balcony access
- Deluxe designer bathroom and Internal laundry
- Air-conditioning; Secure intercom entry with lift access
- Single secured car space

morton.com.au

View

As advertised or by appointment

Agent

Sarah Fowell

 0437 492 129

 sarah@morton.com.au

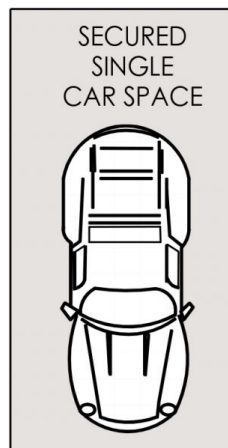
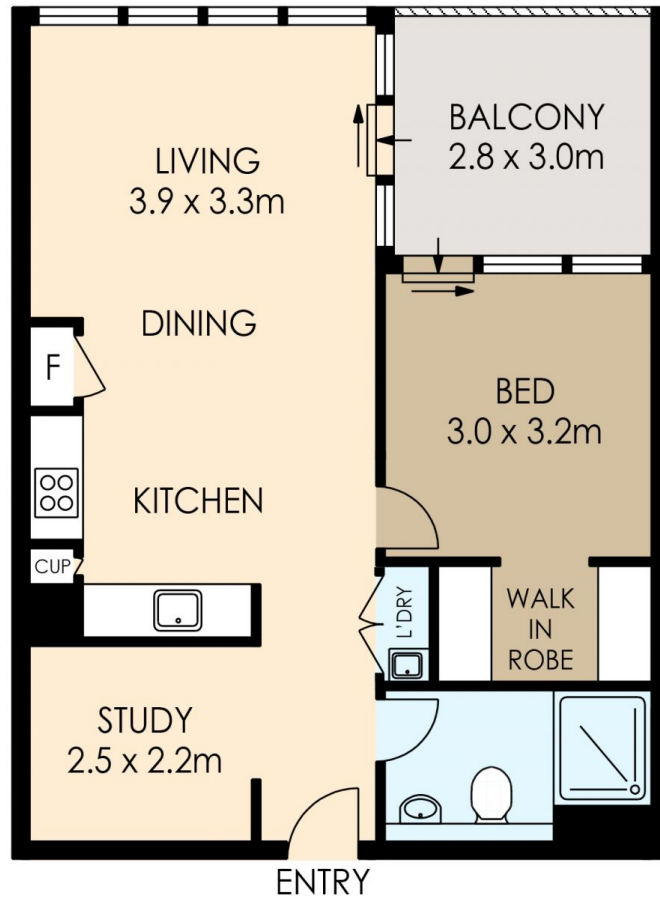

637/2C Defries Avenue, Zetland

The information above is provided in good faith and has been provide to us from a variety of sources. We have not verified whether the information is accurate and do not have any belief one way or other in its accuracy. We do not accept any responsibility to any person for its accuracy and do no more than pass it on. All interested parties should rely on their own inquiries in order to determine whether or not this information is in fact accurate.