



# morton.

**Zetland** 912/1 Hutchinson Walk

 3  2  2

This prized penthouse boasts a vast entertainers' terrace offering panoramic views over tree-lined Joynton Park, the city skyline and the west towards the Blue Mountains. This glamorous 3 bedroom residence defines contemporary living of the highest quality, and affords a superb metropolitan lifestyle with local cafes, bars and restaurants on the doorstep. Recently built in 2014 by highly respected developer Payce, Platinum is fast becoming the areas most coveted addresses.

- Grand entertainers terrace with gas bayonet and outlook of the district
- Sundrenched with a triple north, west, south aspect and views from all rooms
- Magnificent open plan lounge and dining area with floor-to-ceiling windows
- Sleek CaesarStone kitchen with Miele appliances and separate wine fridge
- Spacious master bedroom with built-ins and ensuite
- A further two double bedrooms with built-ins and a study nook

### View

As advertised or by appointment

### Agent

**Sarah Fowell**

 0437 492 129

 sarah@morton.com.au

[morton.com.au](http://morton.com.au)

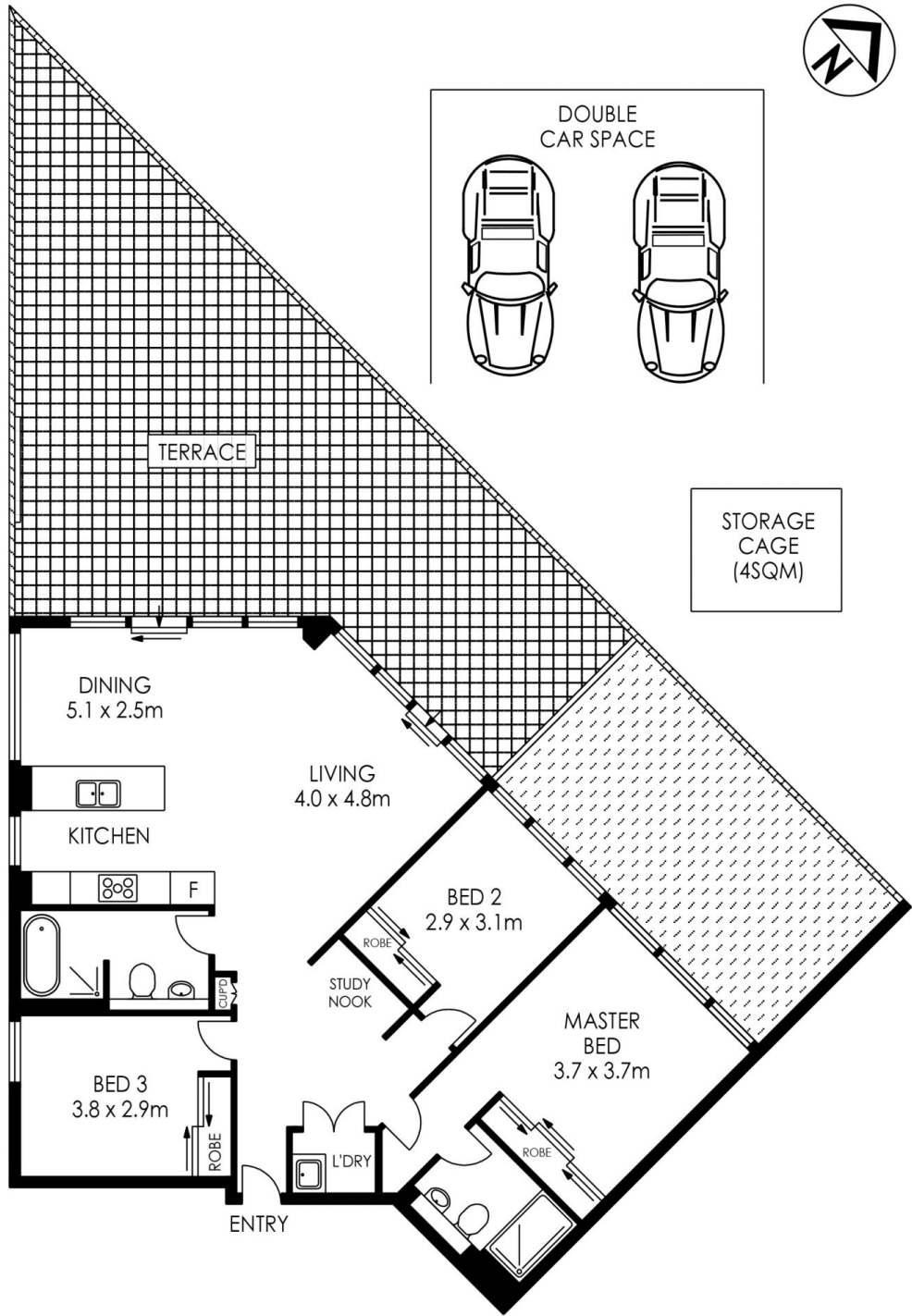

## 912/1 Hutchinson Walk, Zetland

The information above is provided in good faith and has been provide to us from a variety of sources. We have not verified whether the information is accurate and do not have any belief one way or other in its accuracy. We do not accept any responsibility to any person for its accuracy and do no more than pass it on. All interested parties should rely on their own inquiries in order to determine whether or not this information is in fact accurate.