



morton.

ZETLAND 601/2 Victoria Park Parade

 2  2  1

Intuitively crafted with sculpted architectural curves and a strong design aesthetic throughout, this exceptional 80sqm residence is the epitome of modern living. Flooded with natural light courtesy of a prized northern perspective, the elevated sixth floor setting allows for views across the city skyline.

- With well proportioned open plan entertaining areas
- Bright double bedrooms, built-ins, master has ensuite
- Integrated CaesarStone kitchen, chic gas appliances
- Sun-washed balcony, ample storage, floating floors
- 3sqm storeroom, intercom security, European laundry
- Impeccably finished interiors with no expense spared

View

As advertised or by appointment

Agent

Sarah Fowell

 0437 492 129

 sarah@morton.com.au

morton.com.au

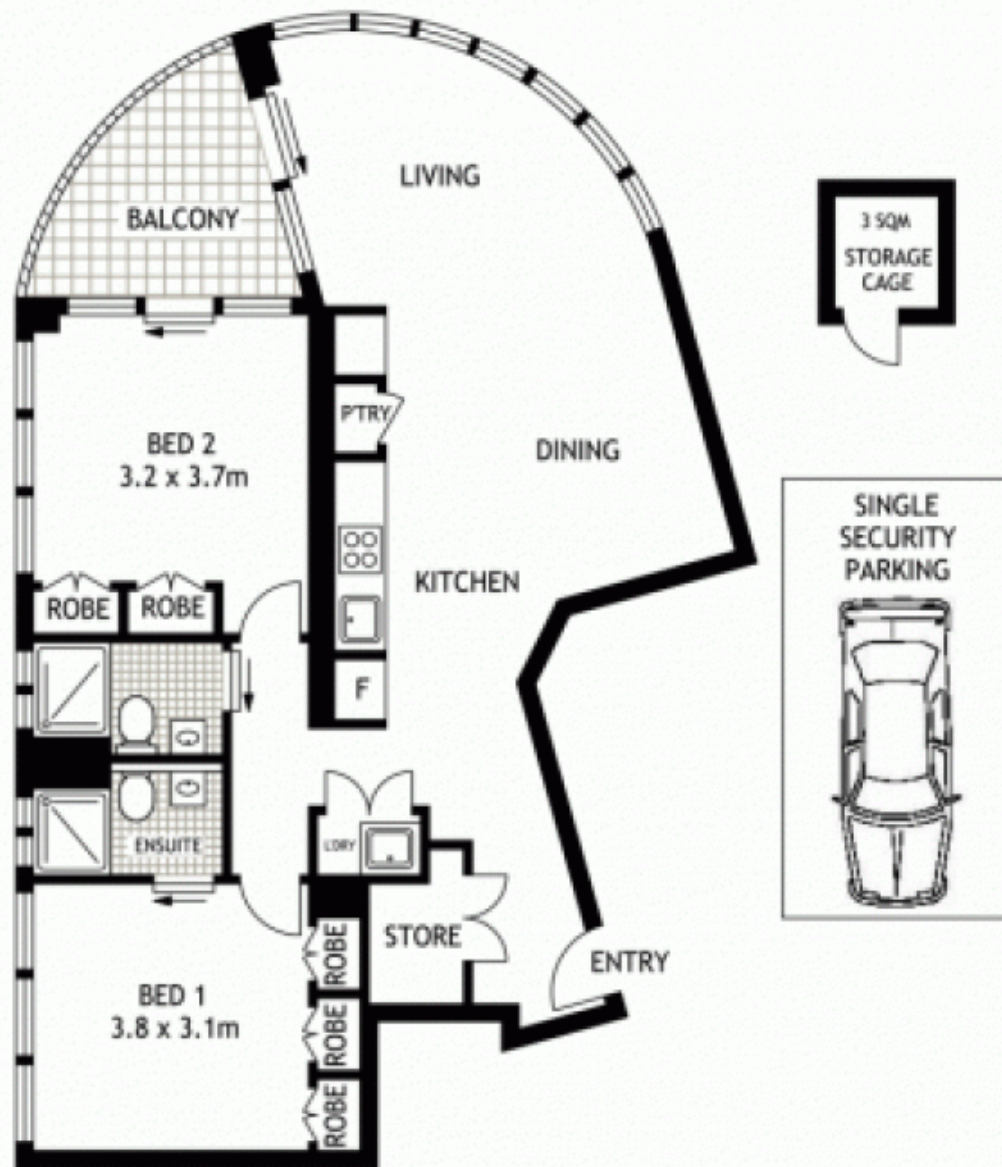

SIXTH FLOOR



601/2 VICTORIA PARK PARADE

ZETLAND

SCAPE Floor Planning Disclaimer: This floor plan is conceptual only. It is provided for illustrative purposes only and should not be relied upon. We make no guarantees to the correctness of this plan. All interested parties should make and rely on their own enquiries in determining the accuracy of the information contained in this floor plan.