



morton.

ZETLAND 1/19 Gadigal Avenue

 1  1

Peacefully set in Victoria Park - one of the East's most coveted lifestyle communities - this stunning dual level residence is designed for ultra modern living. The ideal addition to an investment portfolio or first home, it is simply a matter of minutes to both eastern beaches and the city centre.

- With an inviting open plan lounge and dining space
- Stylishly appointed with quality contemporary finishes
- Integrated CaesarStone kitchen with gas appliances
- Generous 'loft-style' master bedroom, built-in robes
- An expected rental return of approximately \$525 pw
- Polished floors, soaring ceilings, balcony, int. laundry
- Convenient setting metres to landscaped parklands

View

As advertised or by appointment

Agent

Sarah Fowell

 0437 492 129

 sarah@morton.com.au

morton.com.au

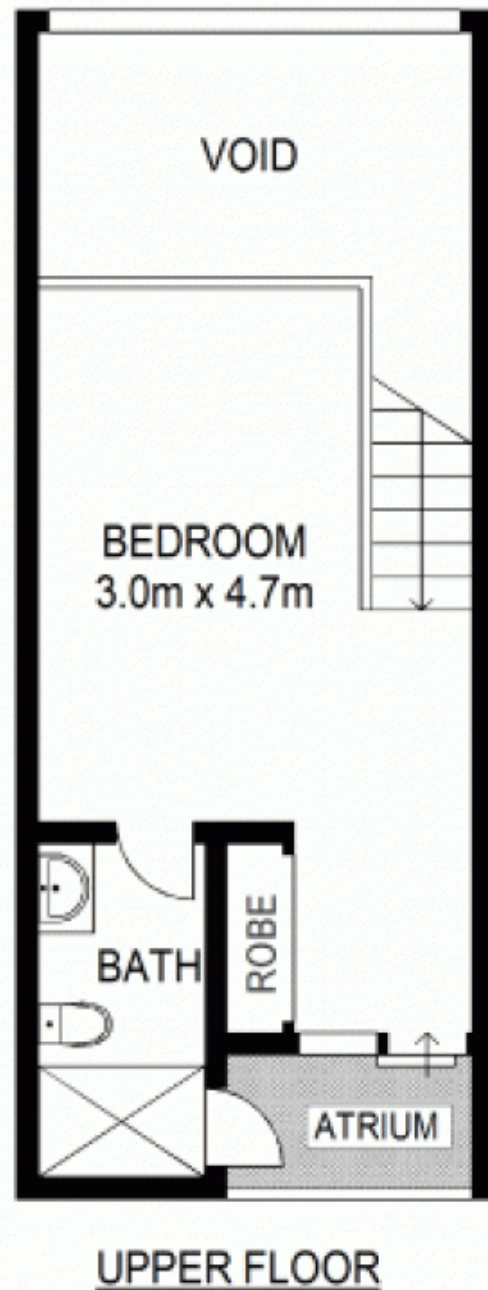
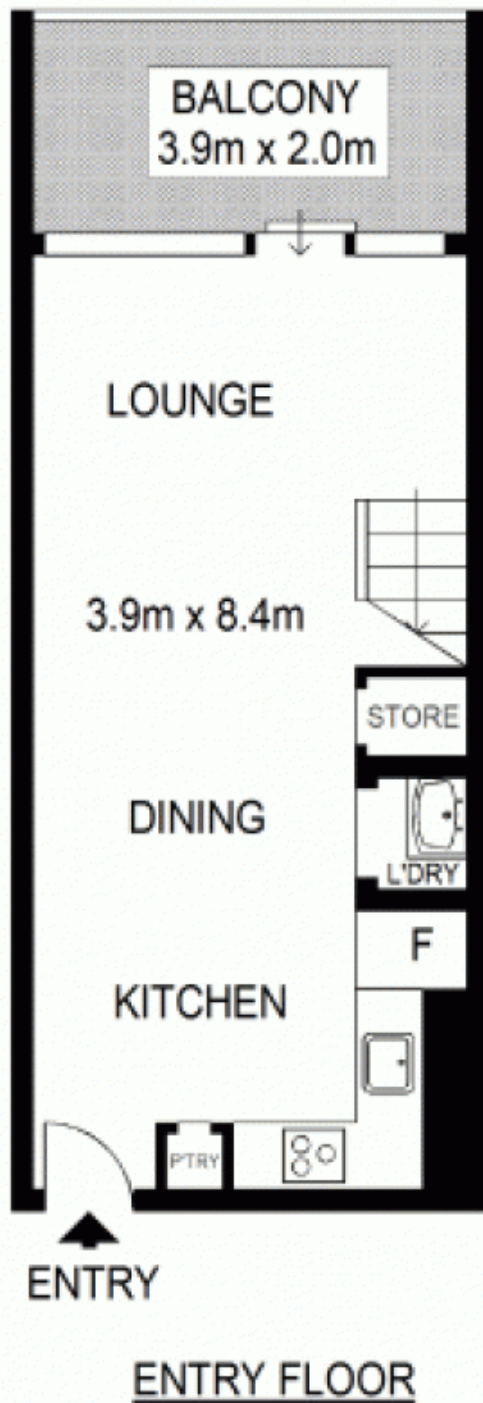

Scale shown in metres. All dimensions herein are approximate and gathered from sources believed to be reliable. Whilst every effort is made for the accuracy of our floor plans, interested parties should rely on their own enquiries. Floor Plans by Industrie Media | industriemedia.tv