



morton.

SURRY HILLS 1025/20 Pelican Street

 1  1

Set high in 'Monument', one of Sydney's most recognised communities, this stunning home is the ultimate in sophisticated designer living. An iconic offering from Wood/Marsh Architecture that flows over a welcoming 72sqm, breathtaking views stretch to the harbour and the iconic sails of the Opera House.

- Embracing the warming light of a northern aspect
- Well proportioned open plan lounge and dining
- Sunny balcony, double bedroom with built-in robe
- Study, quality granite kitchen and European laundry
- Pet friendly building with concierge
- Heated outdoor pool, landscaped gardens, gym

View

As advertised or by appointment

Agent

Sarah Fowell



 sarah@morton.com.au

morton.com.au

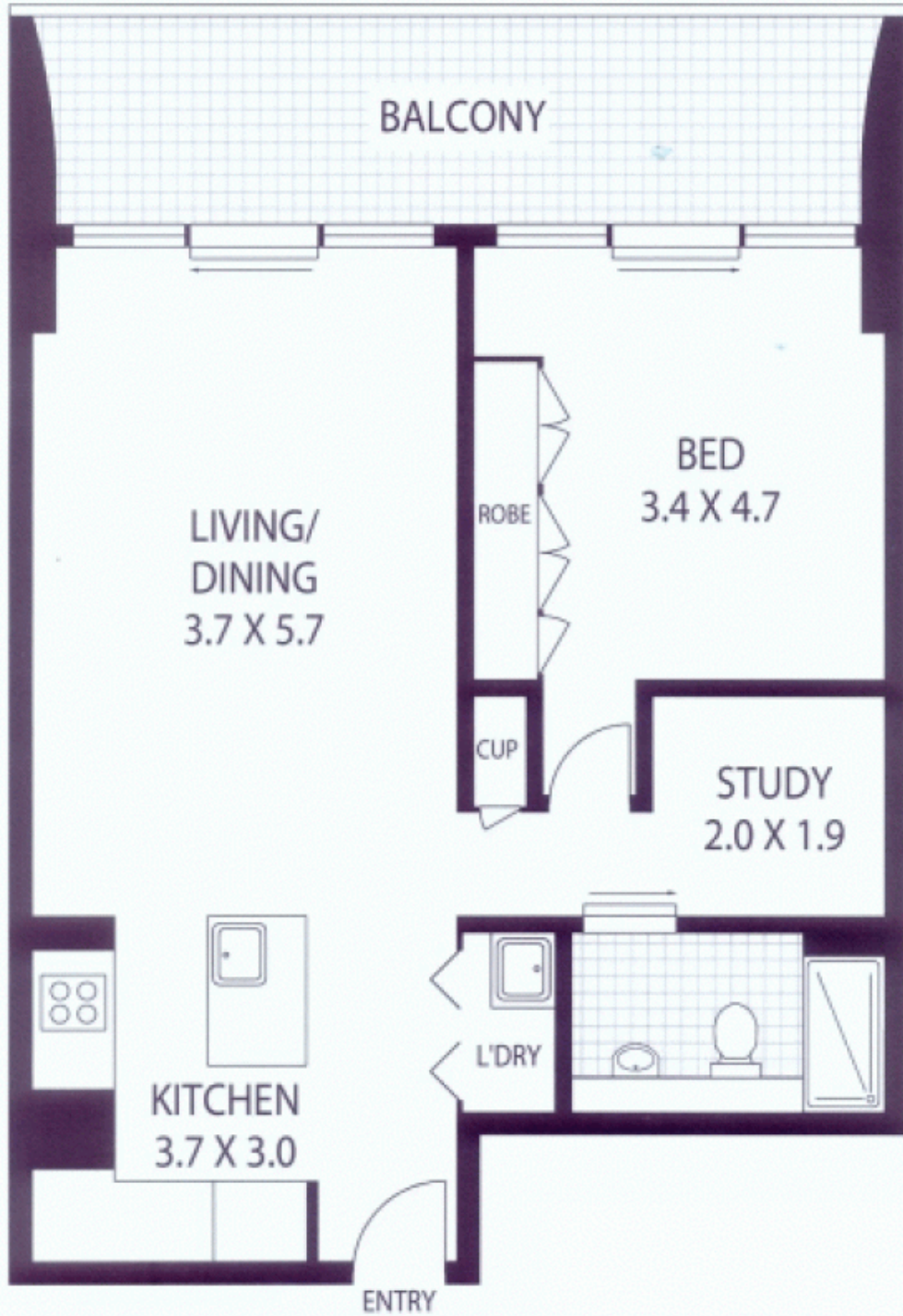

TENTH FLOOR

