



# morton.

**Pyrmont** A201/24-26 Point Street

 3  2  2

Promising lifestyle excellence in the exclusive Watermark complex, this wonderfully spacious apartment provides an idyllic city fringe retreat of contemporary style, quality and ease of living. Enhanced by a cleverly designed layout and plentiful natural light, it reveals open plan lounge and dining areas extending to a generous courtyard.

- Contemporary design features open plan lounge and dining
- Private sunlit wraparound courtyard ideal for entertaining
- Streamlined, modern stone kitchen with Smeg gas appliances
- Well scaled bedrooms appointed with mirrored built-in robes
- All bedrooms open to the courtyard, master with marble ensuite
- Ducted air conditioning, quality full brick construction
- Secure basement parking with two car spaces plus storage

### View

As advertised or by appointment

### Agent

**James Crow**

 0410 593 057

 james@morton.com.au

[morton.com.au](http://morton.com.au)

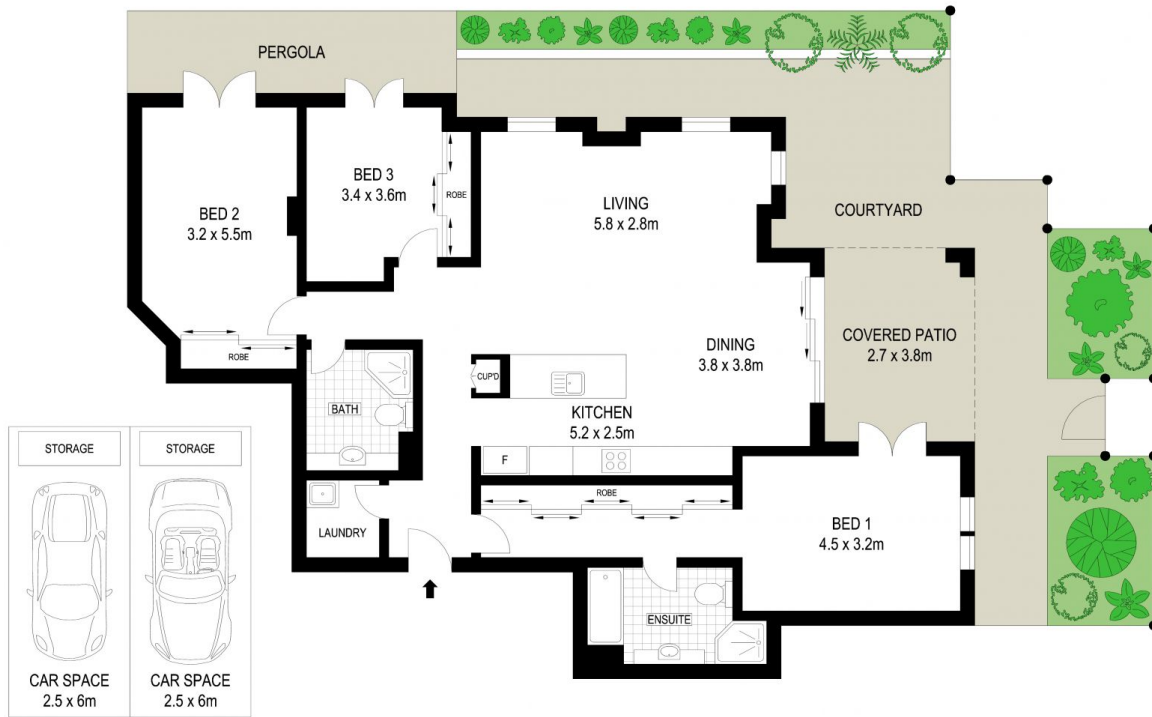

Scale in metres. Indicative only. Dimensions are approximate. All information contained herein is gathered from sources we believe to be reliable. However we cannot guarantee its accuracy and interested persons should rely on their own enquiries.



A201/24 Point Street, Pymont