



morton.

ROZELLE 15/29-31 Alfred Street

 2  1  1

Enviably situated within easy access to the CBD, this generously proportioned townhouse presents an affordable entry point to a highly sought-after location. Perfectly liveable as is, but with scope to add value and modernise with personal updates.

- Easy care lifestyle opportunity in an ultra-convenient locale
- Distinct lounge and dining space
- Easy, open flow to private paved courtyard
- Generous double bedrooms, main with built-in robes
- Separate kitchen, front and rear courtyards
- Internal laundry, main bathroom with separate bath/shower
- Series of in/outdoor living areas with sunny aspects
- Lock up garage, access via Burt Street
- Footsteps to buses, easy access to CBD and moments to parks
- Security complex, currently rented for \$600 per week

View

As advertised or by appointment

Agent

Sarah Fowell

 0437 492 129

 sarah@morton.com.au

morton.com.au

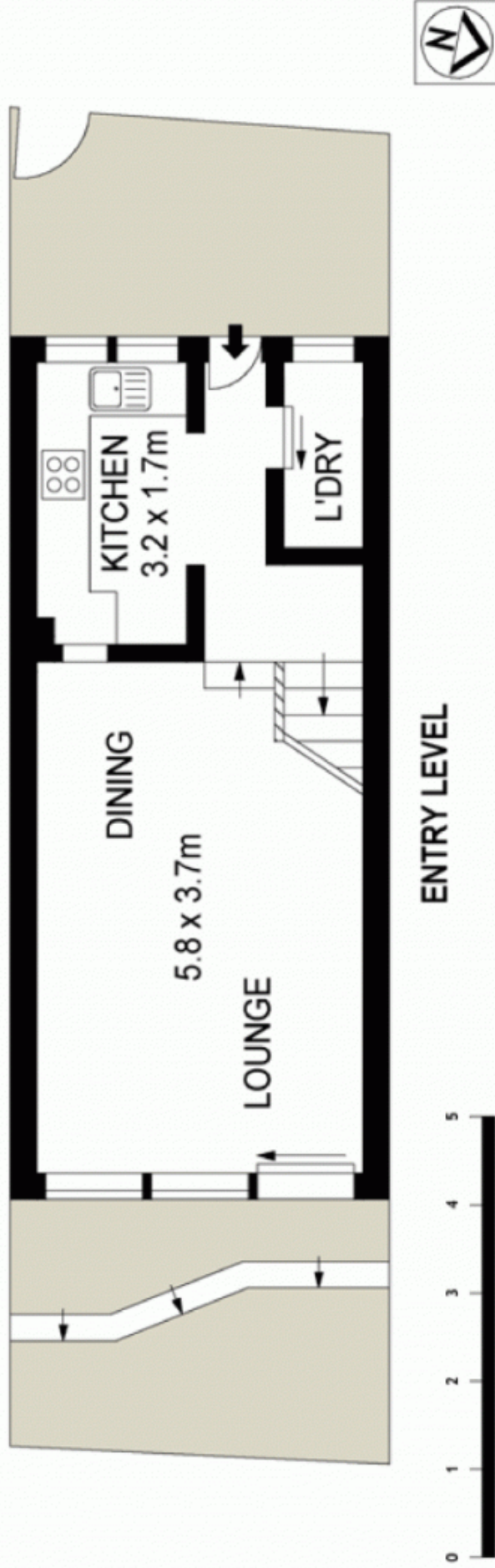
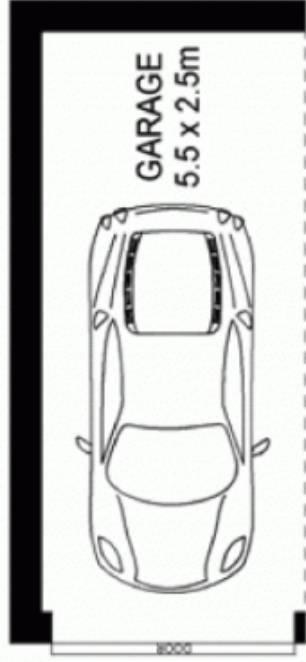
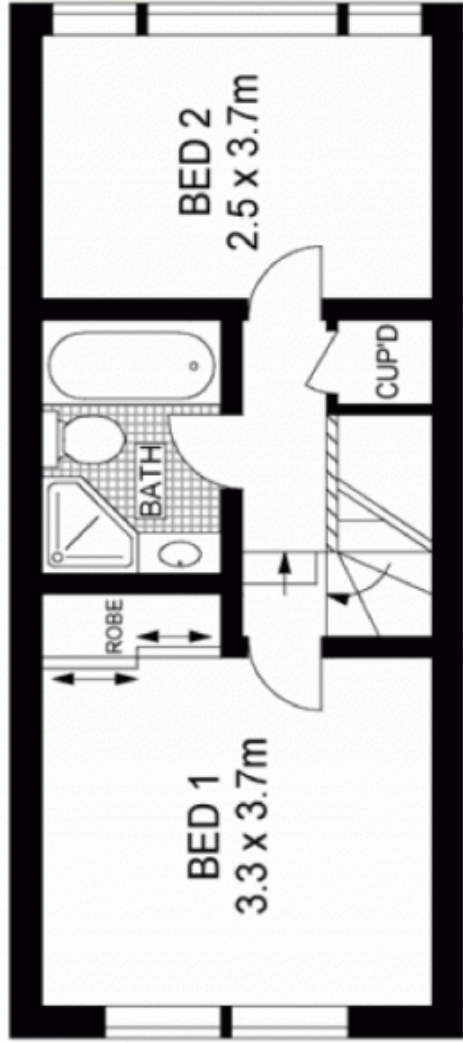

Scale in metres. Indicative only. Dimensions are approximates. All information contained herein is gathered from sources we believe to be reliable. However we cannot guarantee its accuracy and interested persons should rely on their own enquiries.

15/31 Alfred Street, Rozelle