



morton.

Naremburn 23 Rhodes Avenue

 2  1  1

Original homes in this sought-after family setting are increasingly rare to find and this freestanding residence offers a superb canvas for a creative transformation. Set on a north facing 404sqm in one of Naremburn's best cul-de-sac locations, the property is well maintained throughout and is now on the market for the first time in over a century.

- Broad scope to reinvent for the contemporary lifestyle (STCA)
- Large interiors feature high ceilings and polished floors
- Deep north facing garden with private level lawn
- Separate lounge and dining areas plus gas kitchen
- Two double bedrooms plus lock-up garage with storage
- Leafy street within the Cammeray Public School catchment
- On the market for the first time in over a century

View

As advertised or by appointment

Agent

Sarah Fowell

 0437 492 129

 sarah@morton.com.au

morton.com.au

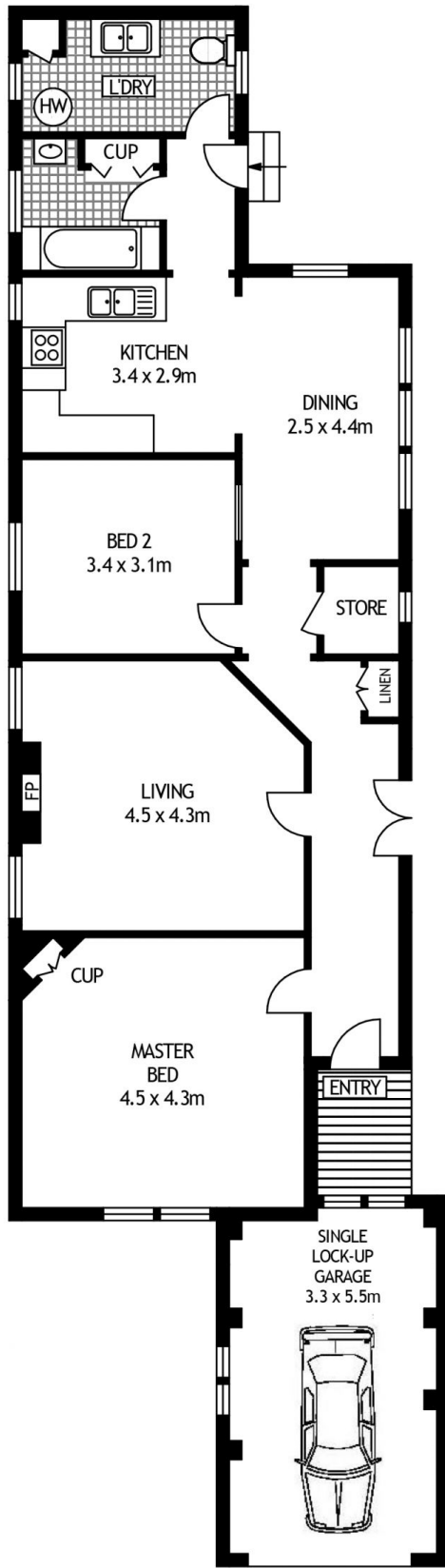

GROUND FLOOR

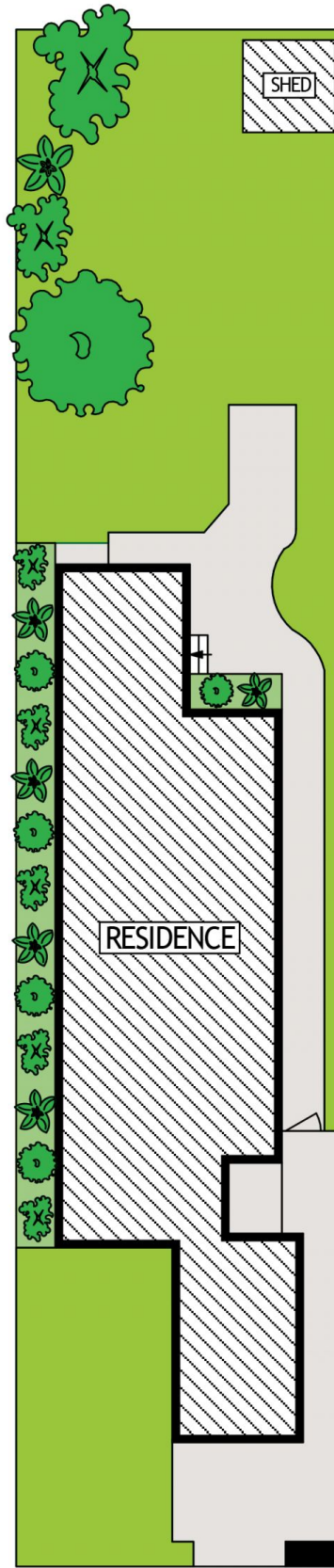

SITE PLAN

