



morton.

ASHFIELD 31/8 Cavill Avenue



Conveniently located, this property is close to public transport and just minutes away from the bustling town centre, including Liverpool Road and Hercules Street. Ashfield is a vibrant and culturally diverse suburb and is a popular destination for shoppers and food lovers from all over Sydney.

Property features:

- Full kitchen with hardwood floor
- Gas cooking appliances
- Modern bathroom with laundry facilities
- Reverse cycle air conditioning
- Natural light
- Balcony
- Security building

View

As advertised or by appointment

Agent

Sarah Fowell

📞 0437 492 129

✉️ sarah@morton.com.au

morton.com.au

**31/8 Cavill Ave,
ASHFIELD**

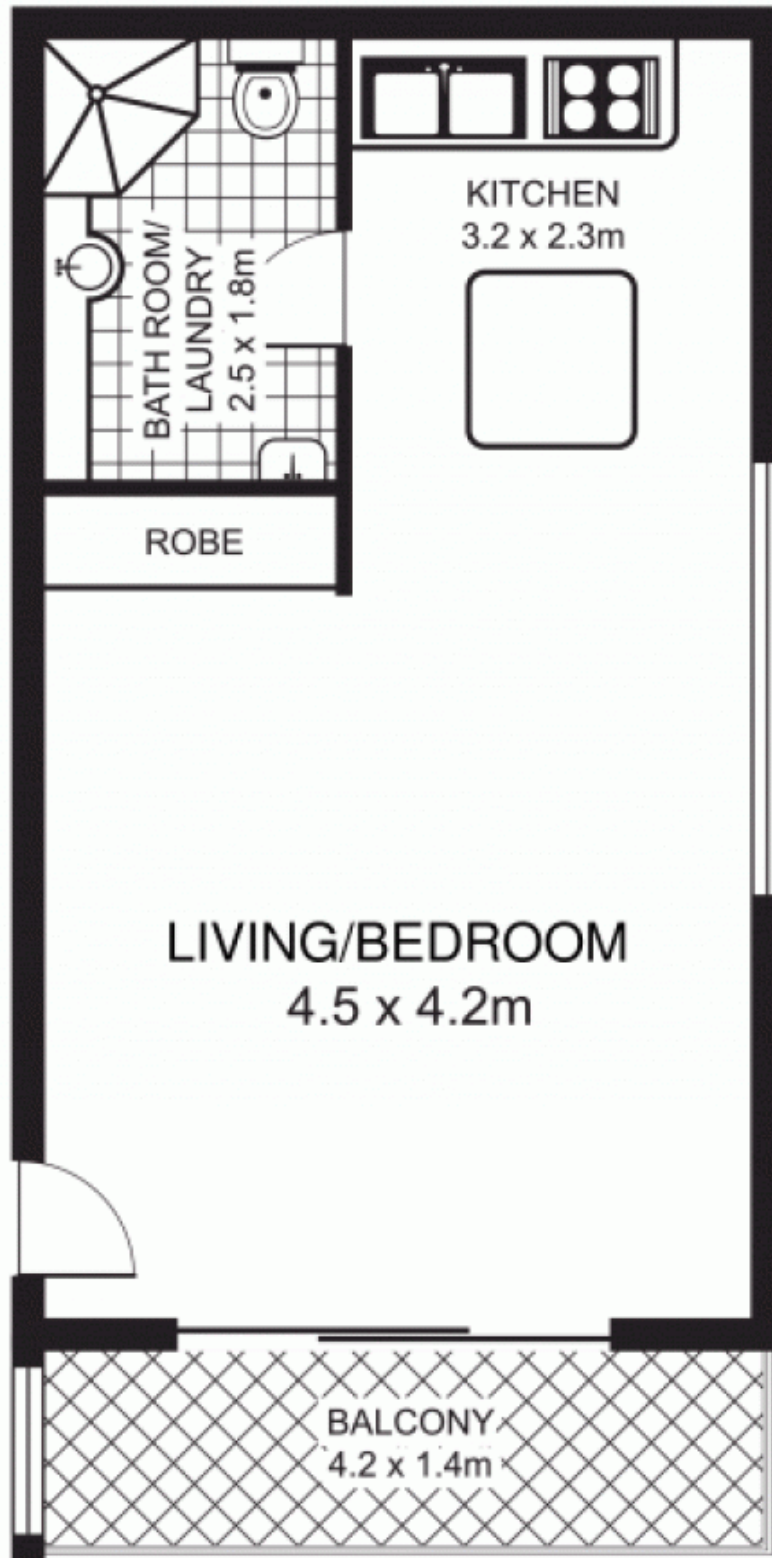

Plans by
surroundpix
com.au
1300 30 32 40

This floor plan is intended as a guide only. Layout dimensions are approximate only. No representations or warranties of any nature whatsoever are given or intended. Any person using this information should rely on their own enquiries