



morton.

Wentworth Point 807/14 Baywater Drive

 2  2  2

Located in Messina, this is your opportunity to move into this two bedroom, two bathroom, and two car apartment. The Waterfront is located only a short stroll from The Promenade and The Piazza, and moments to Marina Square and Wentworth Point's ferry and bus links, Sydney Olympic Park main venues, train station, Bicentennial Park and Millennium Parklands.

Features:

- Located on level eight, North-facing balcony
- Generously sized combined open living and dining
- Full sized kitchen with stainless steel appliances and gas cooking
- Spacious bedrooms with built-in wardrobes
- Master bedroom with en suite and bathtub
- Laundry room and clothes dryer
- Air conditioning
- Double car spaces and storage cage.

View

As advertised or by appointment

Agent

Sarah Fowell

 0437 492 129

 rentals@morton.com.au

morton.com.au

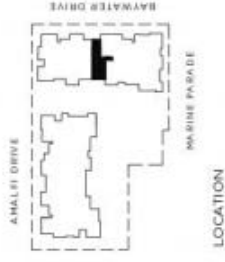

**UNIT 807
2 BEDROOM**

INTERNAL	86 sqm
BALCONY	16 sqm
TOTAL AREA	102 sqm

KEY:

- 1 Entry
- 2 Living
- 3 Dining
- 4 Kitchen
- 5 Bedroom 1
- 6 Bedroom 2
- 7 Wardrobe
- 8 Bathroom
- 9 Ensuite
- 10 Laundry
- 11 Store
- 12 Balcony



28.10.2010
REV. D



Disclaimer: The particulars are intended as a general outline for the purposes of providing information and do not constitute an offer or contract. All measurements, dimensions, volumes, weights, capacities, and necessary permits, delays for approvals and other related or general information should not be relied upon as the basis for any decision or action. The drawings are intended to provide a general impression of the proposed development and are not intended to be a contract. All measurements, dimensions, volumes, weights, capacities, and necessary permits, delays for approvals and other related or general information should not be relied upon as the basis for any decision or action. The drawings are intended to provide a general impression of the proposed development and are not intended to be a contract.

