



morton.

Cambridge Park 4/57-59 Barry Street

 3  2  2

Quietly located in a boutique block of 8 residents, this nicely presented double storey townhouse is positioned at the end of the block features with large landscaped private courtyard, undercover alfresco and a tandem garage. With a few minutes drive to local parks, shops and schools, this as the new spacious townhouse is not to miss.

- Large open living w quality ceramic tiled flooring & large windows
- Off the living is the dining area that connects the kitchen & courtyard
- Modern kitchen with electric cooktop, dishwasher, oven and dual sink
- Large private patio w a sizable undercover entertaining area & clotheslines
- Kingsized master bedroom is downstairs with large ensuite & shower
- A carpeted staircase leads to other bedrooms upstairs, both w built-in robes
- The main bathroom is upstairs w bathtub, sperate shower &

View

As advertised or by appointment

Agent

Amy Torbarina

 0438 977 172

 amy@morton.com.au

morton.com.au



GROUND LEVEL

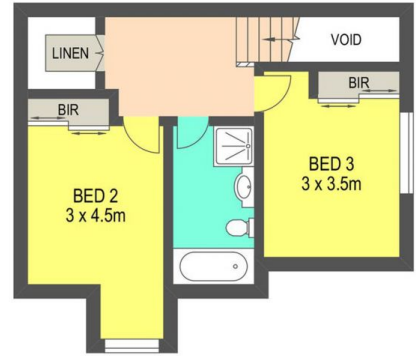

UPPER LEVEL



Disclaimer: The above information has been furnished to us by the vendors of the property, Rpdata Google and independent recourses. We have not verified whether or not the information is accurate and do not have any belief one way or the other in its accuracy. We do not accept any responsibility to any person for its accuracy and do no more than pass it on. All interested parties should make their own inquiries in order to determine whether or not this information is in fact accurate.

4/57-59 Barry Street, Cambridge Park