



morton.

Pyrmont B802/24 Point Street

 2  2  2

The spectacular surrounds of the Sydney skyline, Barangaroo and the Harbour Bridge form a dazzling backdrop to this light filled contemporary apartment. Stylish in its design and generous in its layout, it offers the ultimate city-edge lifestyle with flowing interiors, upgraded quality finishes and a user-friendly floorplan. The prestige Watermark complex is renowned for its superb facilities and great position close to the light rail and Darling Harbour's renowned cafes and restaurants.

- Bright easterly aspect and a generous open plan design
- Wide city-view terrace plus a second rear balcony
- Timber floors throughout and designer lighting
- Sleek stone kitchen fitted with quality gas appliances
- Marble bathrooms, main with bathtub
- Double bedrooms include a master with walk-in and ensuite
- Security parking for two cars plus lock-up storage
- Ducted air-conditioning, intercom entrance and lift access
- Onsite resort facilities include a 25m swimming pool and gym

View

As advertised or by appointment

Agent

Naomie Texier

 0439 247 710

 naomie@morton.com.au

morton.com.au

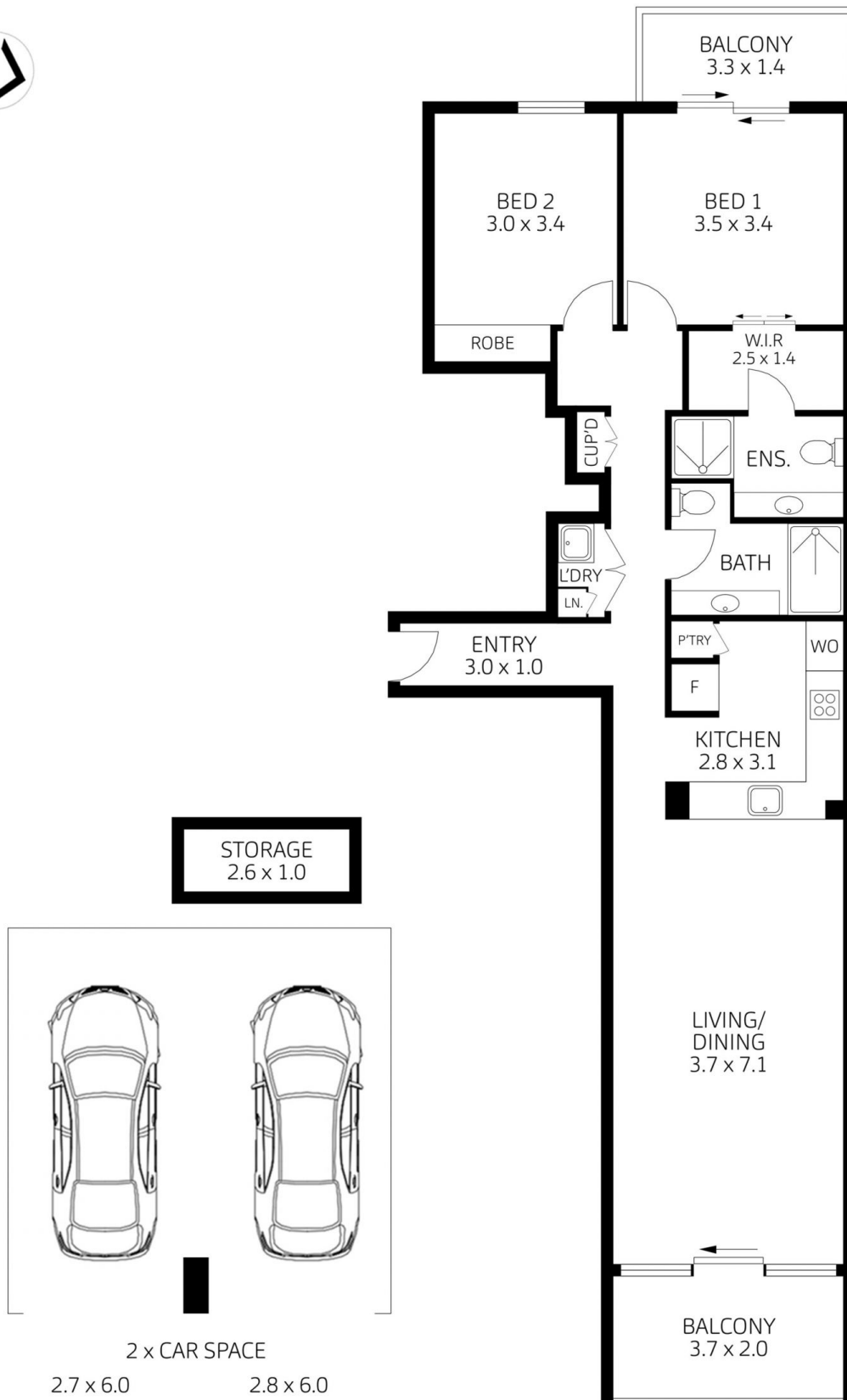

B802/24-26 Point St PYRMONT



This floor plan including furniture, fixture measurements and dimensions are approximate and for illustrative purposes only. Image Mountain gives no guarantee, warranty or representation as to the accuracy and layout. All enquiries must be directed to the agent, vendor or party representing this floor plan.