



# morton.

Wentworth Point 10023/11 Bennelong Parkway

2 1 1

Great opportunity to lease one of the finest and newest apartments at One The Waterfront, an iconic development in Wentworth Point. Located at the foot of Wentworth Point, it is in easy access to transport services to Rhodes, Parramatta and Circular Quay.

- Generous open plan design with latest in décor finishes
- Quality designer kitchen with Bosch built-in appliances
- Bathroom has floor to ceiling tiles, mirrored vanity cabinet
- Spacious bedrooms with built-in robe
- Internal laundry with dryer, air-conditioning, fast speed fiber internet
- Security parking plus storage cage, video intercom life access
- Beautiful roof top garden with BBQ areas, onsite building manager
- Views to the water, parklands and the CBD skylines
- Close to restaurants, Olympic Park, ferry wharf and specialty stores

### View

As advertised or by appointment

### Agent

**Sarah Fowell**

0437 492 129

rentals@morton.com.au

[morton.com.au](http://morton.com.au)

BUILDING  
ONE B



Disclaimer: This plan is a guide only and does not constitute an offer or contract. Please note changes may be made during the development and areas, fittings, fixtures and specifications are subject to change without notice in accordance with the terms of the contract of sale. All parties must rely on their own investigation to validate this information as it is not guaranteed. No liability will be accepted for any necessary measurement. (Date Issued 05/09/2018)

# ONE

THE WATERFRONT

APARTMENT | LOT  
**10023** | **72**

2 Bed + 1 Bath + Study

INTERNAL 83m<sup>2</sup>  
*incl. All Seasons Living Room*

TOTAL 83m<sup>2</sup>

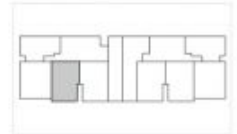

BUILDING ONE B LEVEL 10

ONE THE WATERFRONT DISPLAY CENTRE  
Shop 4E, The Piazza, 21 Bennelong Parkway  
Wentworth Point NSW 2127  
1300 865 465 [onethewaterfront.com.au](http://onethewaterfront.com.au)

DEVELOPED BY **PIETY THP** SALES BY **LINK**