



# morton.

**Pyrmont** B802/24 Point Street

 2  2  2

With respect to the government's easing of restrictions around open homes but in a continuing effort to help stop the spread of COVID-19, we will conduct our scheduled open homes with social distancing and hygiene protocols in place, as well as continue to offer private appointments for those who prefer that method.

Please contact the listing agent for more information.

The spectacular surrounds of the Sydney skyline, Barangaroo and the Harbour Bridge form a dazzling backdrop to this light filled contemporary apartment. Stylish in its design and generous in its layout, it offers the ultimate city-edge lifestyle with flowing interiors, upgraded quality finishes and a user-friendly floorplan. The prestige Watermark complex is renowned for its superb facilities and great position close to the light rail and Darling Harbour's renowned cafes and restaurants.

- Bright easterly aspect and a generous open plan design
- Wide city-view terrace plus a second rear balcony

[morton.com.au](https://www.morton.com.au)

### View

As advertised or by appointment

### Agent

**Sarah Fowell**

 0437 492 129

 [sarah@morton.com.au](mailto:sarah@morton.com.au)

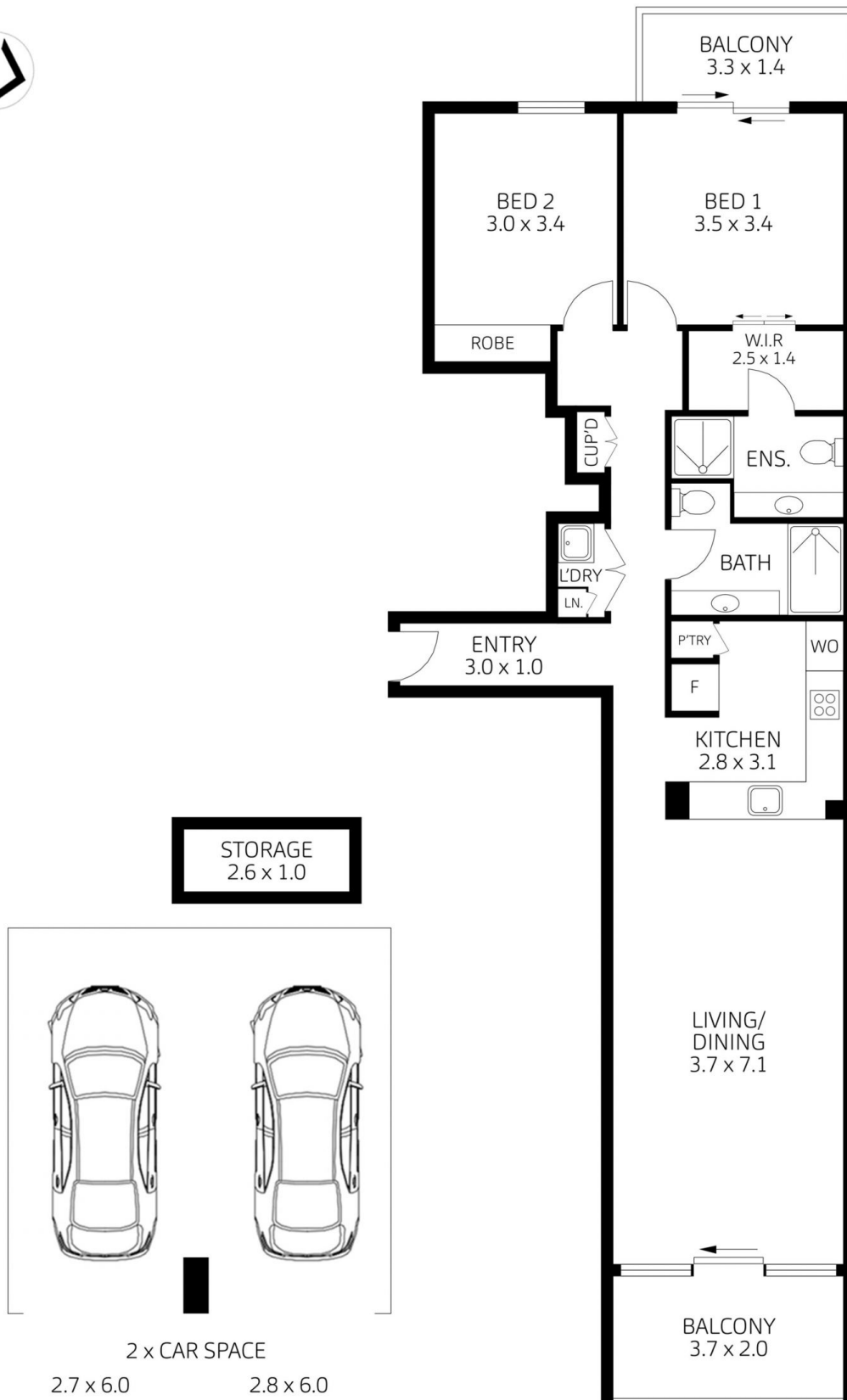

## B802/24-26 Point St PYRMONT



This floor plan including furniture, fixture measurements and dimensions are approximate and for illustrative purposes only. Image Mountain gives no guarantee, warranty or representation as to the accuracy and layout. All enquiries must be directed to the agent, vendor or party representing this floor plan.