



# morton.

**Sydney** 805/45 Shelley Street

 2  2  1

This is a wonderful chance to secure a top floor, north facing executive two bedroom apartment located at the prestigious King Street Wharf development. This apartment's practical design allows for great ventilation and offers complete privacy, with sparkling harbour vistas spanning from Pyrmont across to Balmain.

- Sun soaked living area with plenty of natural light
- Large private balcony, floor to ceiling glass
- Spacious double bedrooms with built ins, master with ensuite
- Sleek kitchen is finished with high quality appliances
- Designer bathroom has a concealed laundry with dryer
- Security building, audio visual intercom and security access
- Moments from the CBD and Sydney's vibrant Darling Harbour
- Chilled water supply for air conditioning in every room

### View

As advertised or by appointment

### Agent

**Morton**

 [info@morton.com.au](tel:)

[morton.com.au](http://morton.com.au)

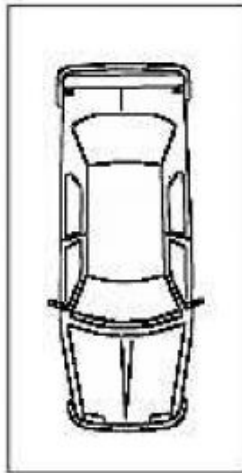

NOTE : ONE CAR SPACE  
AVAILABLE ON  
SECURITY PARKING

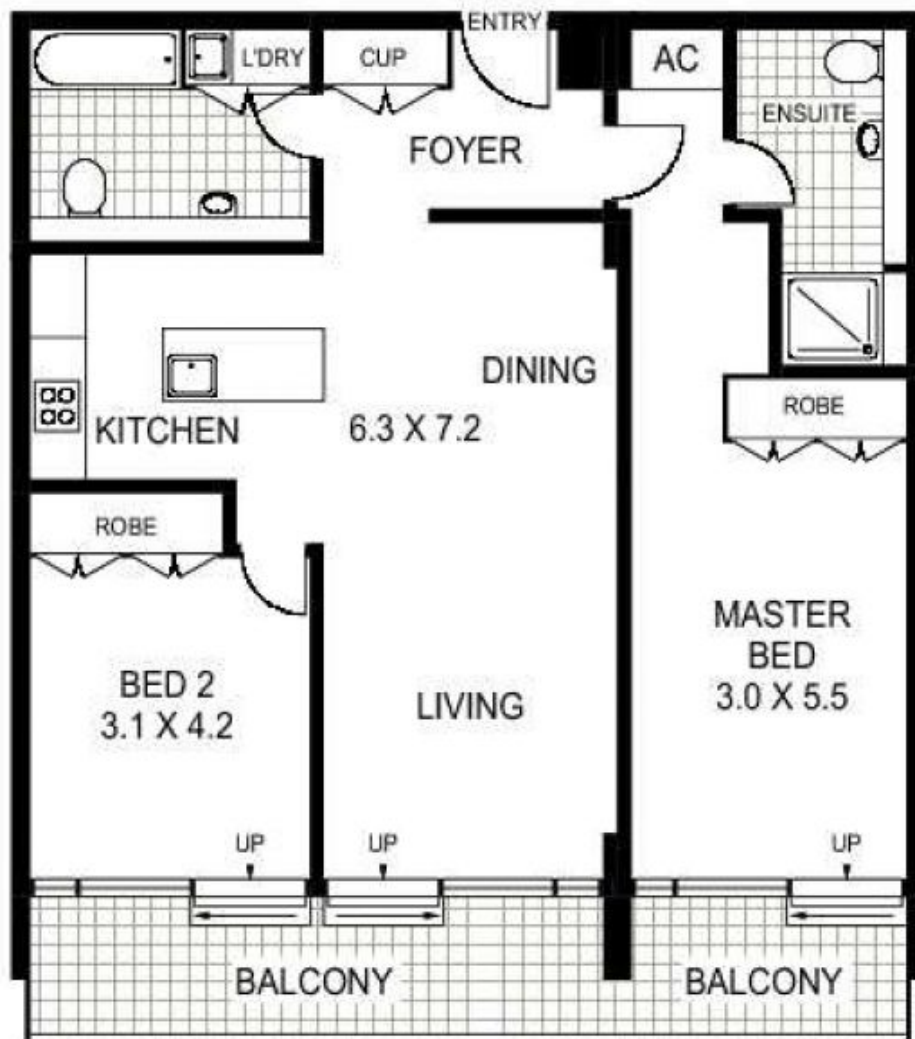

805/45 SHELLEY STREET

SYDNEY

Floor Plan Disclaimer: Mind the Gap (mtg) floor plans / site plans are intended as a guide only. No representations or warranties of any nature whatsoever are given or intended and any person using this information should always rely on their own enquiries. mtg property marketing services - 1300 133 145 - photography, floor plans, virtual tours, video tours, copywriting, project marketing - [www.mindthegap.com.au](http://www.mindthegap.com.au)