



Your wellbeing is our #1 priority morton.

- We're great communicators!**
Our 24/7 onsite specialist technicians.
- Quick response to your needs.**
Morton care you've experienced first-hand. We'll be there for you before you even know you need us.
- If you have any work or building complaints.**
Please don't wait. We'll get it sorted for you.
- Quick access to**
If you have been contacted in the past 14 days.
- The experts are available.**
24/7 phone or email.

morton.

Penrith 303/81B Lord Sheffield Circuit

🛏 2 🚿 2 🚗 1

With respect to the government's easing of restrictions around open homes but in a continuing effort to help stop the spread of COVID-19, we will conduct our scheduled open homes with social distancing and hygiene protocols in place. Our preference is to continue to offer private appointments however public inspections will be available for some properties. Please contact the listing agent for more information.

Thornton Central apartments located on the north side of Penrith train station with park and district views, some with water views towards the picturesque Blue Mountains, situated in the master-planned community Thornton Estate, offering convenient apartment living only metres to Westfield shopping centre, local parks and quality restaurants and cafes.

Features include:

- Lv 3, Northeast facing, covered balcony with garden views
- Reverse cycle A/C in living and bed, block-out roller blinds throughout

morton.com.au

View

As advertised or by appointment

Agent

Amy Torbarina

📞 0438 977 172

✉ amy@morton.com.au

Apartment

2 BED - B 303

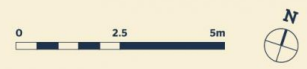
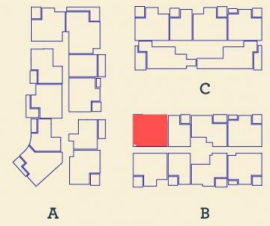

Internal	76 m ²
External	8 m ²
Total	84 m²

DATE ISSUED 27/07/2015
VERSION 02

Developed by **St Hilliers** **FIRST POINT PROJECTS** | Sales by **LINK** **Home LandDirect** thorntoncentral.com.au

Disclaimer: This floor plan has been prepared for marketing purposes only. All descriptions, dimensions, depictions and other details in this floor plan together, the "Information" may not be to scale. The vendor reserves the right to vary or amend the Information without notice. The Information may vary from the actual dimensions, layout and characteristics of the property as built. No third party has any authority whatsoever, either expressly or impliedly, to make or give any representation or warranty or to bind the vendor in connection with the information or the property.

THORNTON