



Your wellbeing is our #1 priority

morton.

-  **When going independent & out**
Our 24hr on-site specialist assistance
-  **Check hygiene in your tenancy**
Make sure you're qualified your tenancy throughout before entering the premises
-  **If you have any child or life like complaints**
Please do not enter the premises
-  **Don't come in**
If you have been overseas in the past 14 days
-  **The agents are available**
By phone or email

morton.

Sydney 393/27 Park Street

 2  2

With respect to the government's restrictions around open homes and to help stop the spread of COVID-19, our properties can be viewed by appointment only. Please contact the listing agent for more information.

Featuring a panoramic North/East aspect over Hyde Park, The Domain, Sydney Harbour & the City lights, this is a view normally reserved for luxury penthouse apartments. Parking available at additional cost, if required.

Residents of this iconic security building enjoy access to a roof top pool, sun deck, laundry and table tennis area.

Park Regis is located next to Hyde Park, QVB & Town Hall at 27 Park Street, providing easy access to shops, cafes, restaurants and transport.

Available Now

View

As advertised or by appointment

Agent

Morton RE

  rentals@morton.com.au

[morton.com.au](https://www.morton.com.au)

423 / 27 Park Street, Sydney

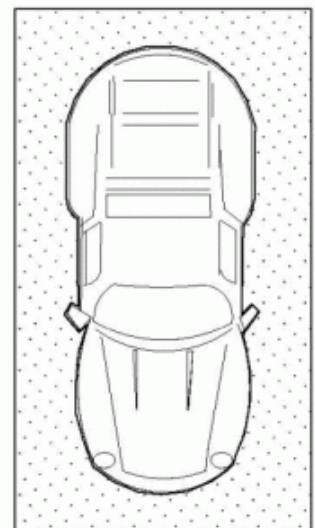
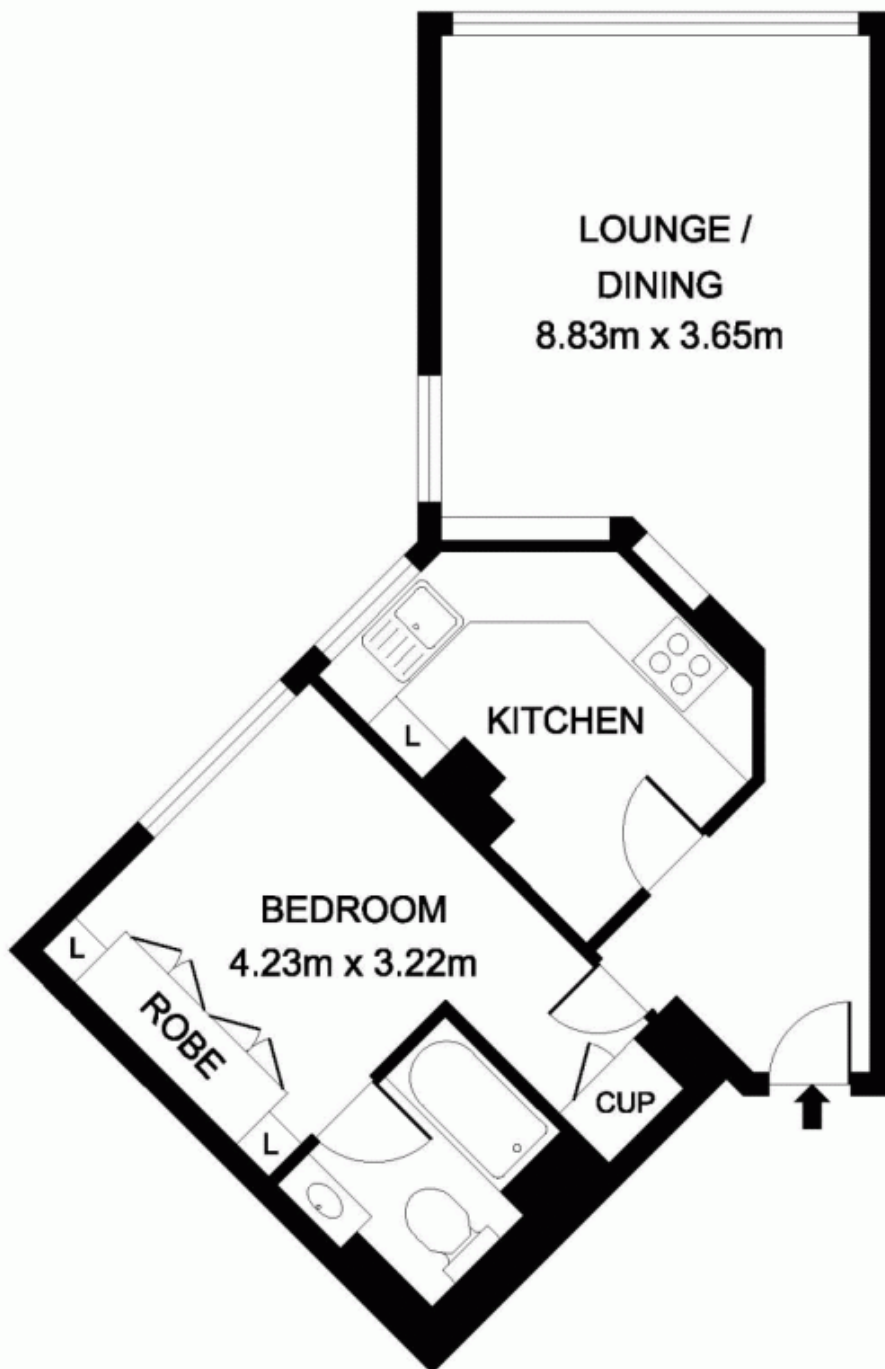

SINGLE
CAR SPACE