



morton.

Wentworth Point 105/27 Bennelong Parkway

 2  2  1

With respect to the government's restrictions around open homes and to help stop the spread of COVID-19, our properties can be viewed by appointment only. Please contact the listing agent for more information.

The Waterfront is located moments to Sydney Olympic Park main venues, train station, Bicentennial Park and Millennium Parklands. Located in Mariners' Cove, this is your opportunity to move into this two bedroom apartment only a short stroll from The Promenade and The Piazza.

- Full kitchen with plenty of cupboard space
- Loads of natural light flowing into the living area
- Good size bedrooms with built-in wardrobes
- Laundry room with clothes dryer
- Balconies allowing natural ventilation overlooking the Mariners pool
- Split system air conditioning in both bedrooms
- Single car space

View

As advertised or by appointment

Agent

Sarah Fowell

 0437 492 129

 rentals@morton.com.au

morton.com.au

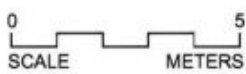

DISCLAIMER

NO RESPONSIBILITY TAKEN FOR INFORMATION PROVIDED HEREIN.
 INTERESTED PARTIES SHOULD RELY ON THEIR OWN ENQUIRIES
 AND THE CONTRACT FOR SALE. CARPARK AREAS NOT INCLUDED,
 REFER TO STRATA PLANS FOR ADDITIONAL INFORMATION.

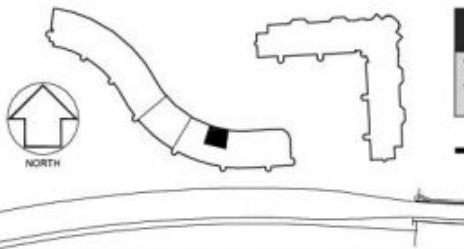

APARTMENT 105

2 BEDROOM

INTERNAL AREA 74 sqm
 EXTERNAL AREA 46 sqm
 TOTAL AREA 120 sqm

MARINERS COVE

RESIDENTIAL APARTMENTS

27 Bennelong Road
 Homebush Bay