



morton.

Waterloo 2.01/830 Elizabeth Street

 3  2  1

With respect to the government's restrictions around open homes and to help stop the spread of COVID-19, our properties can be viewed by appointment only. Please contact the listing agent for more information.

Offering the perfect balance of a timeless heritage building, industrially inspired designs, and bespoke apartments; Sydney's latest development 'Iconic' has set a new standard in living within Waterloo.

Iconic Waterloo has embraced its status as a boutique development by maintaining the building's heritage as well as introducing industrial and luxury elements; thus establishing something truly amazing.

- Lots of internal storage
- Internal laundry with dryer
- Large modern kitchen with integrated fridge; dishwasher and gas miele appliances

morton.com.au

View

As advertised or by appointment

Agent

Sarah Fowell

 0437 492 129

 sarah@morton.com.au



APARTMENT
2.01

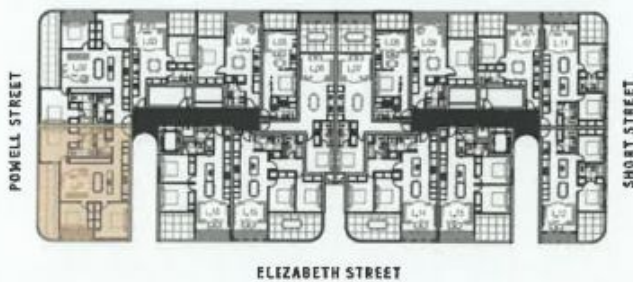

Bedrooms:	3
Bathrooms:	2
Carspace:	1
Internal area:	105 sqm
Outdoor area:	24 sqm
Total area:	129 sqm



level 2

Disclaimer: Floor Plan measurements are approximate and are for illustrative purposes only. While we do not doubt the floor plans accuracy, we make no guarantee, warranty or representation as to the accuracy and completeness of the floor plan. Please refer to the 'draft strata plan' for precise measurements of each floor plan within the ICONIC Development.