



morton.

Your wellbeing is our #1 priority

morton.

- When going international?**
Get a mobile specialist visit.
- Don't forget to be your best.**
Make sure you're qualified and your health is up to date before entering the program.
- If you have any cold or flu like symptoms,**
please do not come to work.
- Don't come to**
if you have been overseas in the past 14 days.
- The app is available**
by phone or email.

Sydney 393/27 Park Street

2 2 1

With respect to the government's restrictions around open homes and to help stop the spread of COVID-19, our properties can be viewed by appointment only. Please contact the listing agent for more information.

Featuring a panoramic North/East aspect over Hyde Park, The Domain, Sydney Harbour & the City lights, this is a view normally reserved for luxury penthouse apartments.

Residents of this iconic security building enjoy access to a roof top pool, sun deck, laundry and table tennis area.

Park Regis is located next to Hyde Park, QVB & Town Hall at 27 Park Street, providing easy access to shops, cafes, restaurants and transport.

Available Now

View

As advertised or by appointment

Agent

Morton RE

rentals@morton.com.au

morton.com.au

423 / 27 Park Street, Sydney

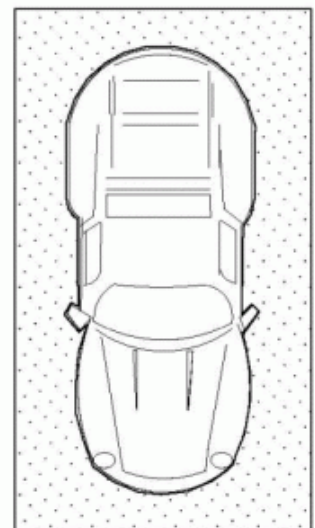
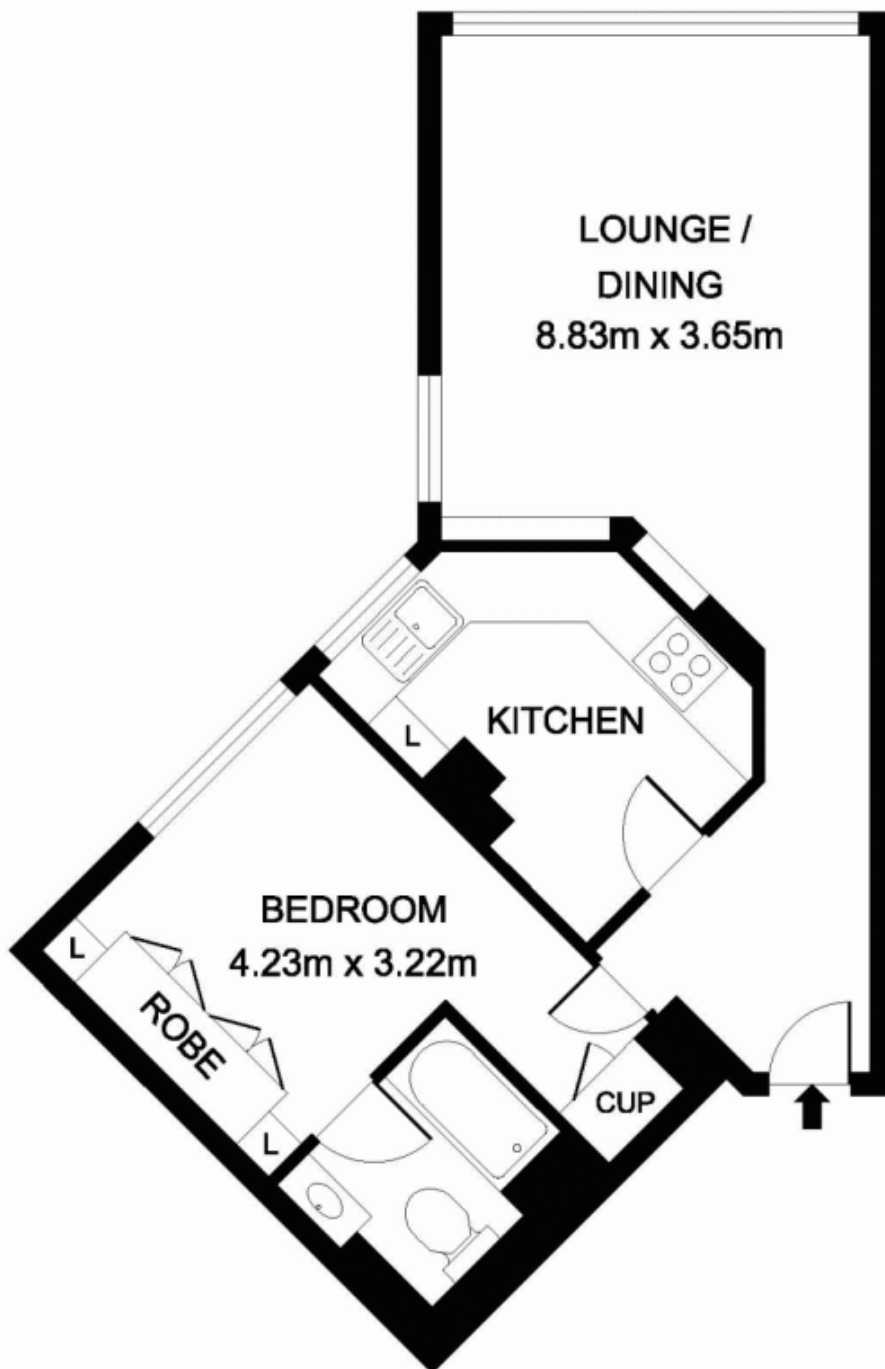

SINGLE
CAR SPACE