



# morton.

**Zetland** 2207/6 Ebsworth Street

🛏 2 🚿 2 🚗 1

This two bedroom apartment with city views is located on the 22nd floor in the near new building "OVO". Featuring top end finishes with high quality appliances this building is second to none. Close to public transport and just 3kms to the CBD this apartment has everything inner city living has to offer.

- North facing
- Electric blinds throughout
- Reverse cycle air conditioning
- Modern gas kitchen with stainless steel appliances and dishwasher
- Large balcony, perfect for entertaining
- Internal laundry with dryer
- Build-in robes in both bedrooms
- Lots of natural light with large bay windows
- 1 secured car space, 1 motorbike parking plus storage cage

### View

As advertised or by appointment

### Agents

#### Sarah Fowell

📞 0437 492 129  
✉ sarah@morton.com.au

#### George Reale

📞 0408 014 469  
✉ george@morton.com.au

[morton.com.au](http://morton.com.au)

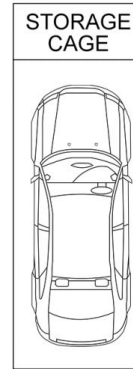
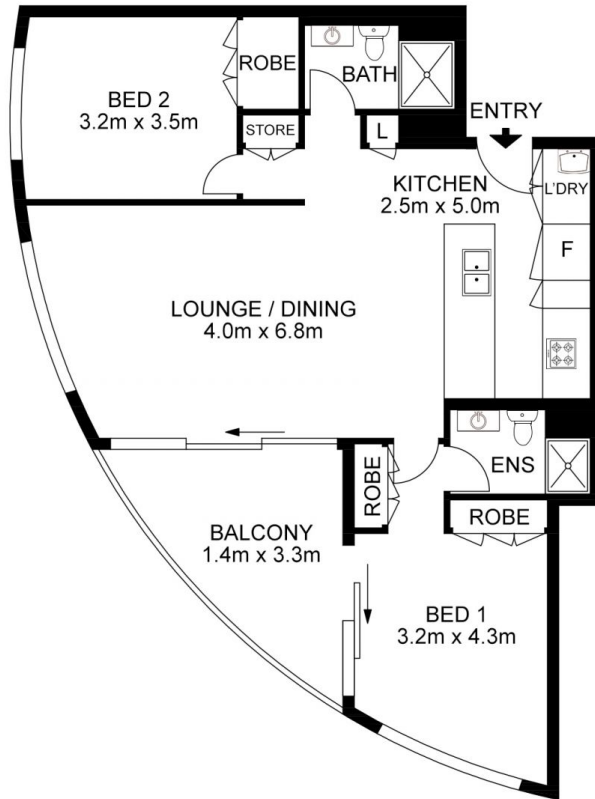

CAR SPACE  
2.3m x 5.5m

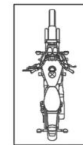

MOTORCYCLE SPACE  
1.3m x 2.5m

All information contained herein is gathered from all sources we believe to be reliable. However we cannot guarantee its accuracy and interested parties should rely on their own enquiries.

