



morton.

Wentworth Point A607/1 Burroway Road

1 1 1

Jewel is set to be the new and iconic gateway that connects the Sydney Harbour to Wentworth Point. Ideally positioned at the northern tip of the peninsular, Jewel is opposite to the ferry wharf, bus stops and rests above the Pierside retail precinct that includes restaurants, health care and beauty.

- Entertainers gas kitchen with stone/Corian benchtops, soft closing cupboards
- LED lighting, split system reverse cycle air conditioning
- Open living and dining with timber look ceramic tiles
- Lounge room with gas point and MATV and payTV points
- Wool-blend carpeted bedrooms, mirrored built-in robes
- Internal laundry with dryer, audio intercom with security and lift access
- Bathroom/ensuite with ceramic wall and floor tiles, mirrored vanity cabinet
- Large covered balcony with gas point for BBQ
- Basement secure parking, some with a storage cage
- On-site building manager, common landscaped courtyard

View

As advertised or by appointment

Agent

Sarah Fowell

0437 492 129

rentals@morton.com.au

morton.com.au



JEWEL

WENTWORTH POINT

APARTMENT

607

LOT 43
1BED + STUDY

Internal	59 sqm
External	12 sqm
Total	71 sqm

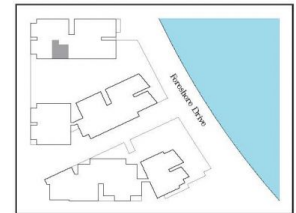

LEVEL 6



GOLD SCREEN FACADE

