



**morton.**

**Wentworth Point** 625/1 Burroway Road

 3  2  2

Jewel is set the new and iconic gateway that connects the Sydney Harbour to Wentworth Point. Ideally positioned at the northern tip of the peninsular, Jewel is opposite to the ferry wharf, bus stops and rests above the Pierside retail precinct that includes restaurants, health care and beauty.

Apartment features:

- Full kitchen with quality appliances
- Separate study nook area
- Bbq on the balcony overlooking the water
- LED lighting, split system reverse cycle air conditioning
- Open living and dining area
- Lounge room with gas point and MATV and payTV points
- Internal laundry with dryer, audio intercom with security and lift access
- Bathroom/ensuite with ceramic wall and floor tiles, mirrored vanity cabinet
- Two car spaces in basement and storage
- On-site building manager, common landscaped courtyard

**View**

As advertised or by appointment

**Agent**

**Sarah Fowell**

 0437 492 129

 [rentals@morton.com.au](mailto:rentals@morton.com.au)

**morton.com.au**

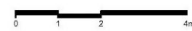

JOINTLY DEVELOPED BY



Disclaimer: This floor plan has been prepared for marketing purposes only. All descriptions, dimensions, depictions and other details in this floor plan may not be to scale and may vary from the property as built. Your attention is drawn to the special conditions of the contract for sale of land. No third party has any authority to make or give any representation or warranty in relation to the property unless the representation or warranty is confirmed by Payce Communications Wentworth Point Pty Ltd. (PCW) Development Pty Ltd and included in the contract for sale of land. SORA disclaimer: In this disclaimer, Developer means Payce Communications Wentworth Point Pty Ltd ACN 168 430 746 and SH Development Pty Ltd ACN 164 28 145. Development means the retail and residential development at Burroway Road Wentworth Point known as Jewel SORA means Sydney Olympic Park Authority, a statutory body constituted under the Sydney Olympic Park Authority Act 2002 (NSW). The Developer is responsible for all matters in connection with understanding and completing all of the works required to be performed or carried out to complete the Development and SORA has no responsibility or involvement in those matters.

SALES BY



(Rev E\_0615 )



# JEWEL

WENTWORTH POINT

APARTMENT  
**625**  
LOT 125  
3BED + STUDY

Internal	109 sqm
External	75 sqm
<b>Total</b>	<b>184 sqm</b>

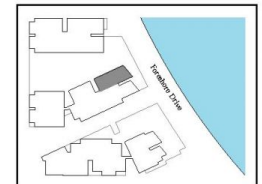

LEVEL 6

**JEWEL DISPLAY CENTRE**

1 Burroway Road, Wentworth Point 2127

1300 888 778 | jewelresidences.com.au