



morton.

Wentworth Point 828/1 Burroway Road

 2  2  1

Jewel exudes luxury, sophistication and elegance from its glittering gold façade to its well appointed premium quality kitchens. Presenting to the market is without a doubt one of the best floor plans available within the building. Located on the 8th floor, this east facing apartment features:

- Bright and spacious 2 bedroom apartment with water views
- Premium Bosch kitchen appliances and gas cooking
- Expansive open plan living flows to a sun-washed balcony
- Separate study room adjacent to entry
- Master bedroom has an ensuite and walk-in robe
- Secure undercover parking and storage cage

View

As advertised or by appointment

Agent

Sarah Fowell

 0437 492 129

 rentals@morton.com.au

morton.com.au



GOLD SCREEN FACADE

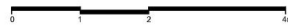

JOINTLY DEVELOPED BY



Disclaimer: This floor plan has been prepared for marketing purposes only. All descriptions, dimensions, depictions and other details in this floor plan may not be to scale and may vary from the property as built. Your attention is drawn to the special conditions of the contract for sale of land. No third party has any authority to make or give any representation or warranty in relation to the property unless the representation or warranty is confirmed by Payce Communities Wentworth Point Pty Ltd and included in the contract for sale of land. SCPA Disclaimer: In this disclaimer Development means Payce Communities Wentworth Point Pty Ltd ACN 604 420 744 and SA FWT Development Pty Ltd ACN 164 28 145. Development means the retail and residential development at Burroway Road Wentworth Point known as Jewel. SCPA means Sydney Olympic Park Authority, a statutory body constituted under the Sydney Olympic Park Authority Act 2002 (NSW). The Developer is responsible for all matters in connection with undertaking and completing all of the works required to be performed or carried out to complete the Development and SCPA has no responsibility or involvement in those matters.

SALES BY



(Rev C_01/06/15)



JEWEL

WENTWORTH POINT

APARTMENT

828

LOT 148

2BED + STUDY

Internal	80 sqm
External	15 sqm
Total	95 sqm

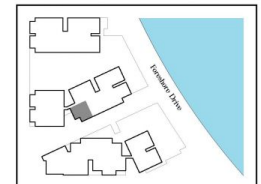

LEVEL 8

JEWEL DISPLAY CENTRE

1 Burroway Road, Wentworth Point 2127

◆ 1300 888 778 ◆ jewelresidences.com.au