



morton.

Wentworth Point 517/16 Baywater Drive

 2  2  1

Situated Catania at The Waterfront, here is your opportunity to move into this two bedroom apartment. Located a short stroll from The Promenade, The Piazza, local restaurants, convenience store, pharmacy, public transport off Hill Road and ferry service to Parramatta and City CBD. The Waterfront is located moments to Sydney Olympic Park main venues and train station, Bicentennial Park and Millennium Parklands.

- Located on level 5
 - Lovely 2 bedroom unit with loads of morning sun
 - Combined living and air conditioning flowing onto covered extra large balcony with views
 - Caesar stone kitchen with the latest stainless steel Omega appliances, walk-in robe and en-suite to main bedroom, built-in cupboard to second room.
- Comfortable size apartment in great position, laundry room with clothes dryer and pantry, single car space and storage cage.

View

As advertised or by appointment

Agent

Morton RE



 rentals@morton.com.au

morton.com.au

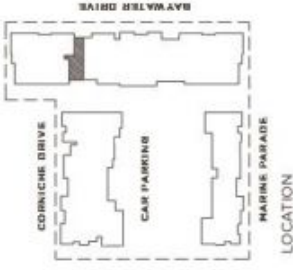

LOCATION

UNIT 517 2 BEDROOM

INTERNAL 84 sqm
BALCONY 15 sqm
TOTAL AREA 99 sqm

KEY:

- 1 Entry
- 2 Living
- 3 Dining
- 4 Kitchen
- 5 Bedroom 1
- 6 Bedroom 2
- 7 Wardrobe
- 8 Study
- 9 Bathroom
- 10 Ensuite
- 11 WC
- 12 Laundry
- 13 Store
- 14 Balcony/Courtyard



REV. A



Disclaimer: The particulars are set out as a general guide for the purposes of planning purchases and should not be relied upon as a contract. All dimensions, descriptions, references to conditions and technical specifications for work and other details are given in good faith and are believed to be correct. We are providing purchasers with our best information at the time of writing. We do not warrant the accuracy or completeness of the information provided. We do not warrant the accuracy or completeness of the information provided. We do not warrant the accuracy or completeness of the information provided. We do not warrant the accuracy or completeness of the information provided.