



**morton.**

**Wentworth Point** 830/1 Burroway Road

 2  2  1

Jewel is iconic gateway that connects the Sydney Harbour to Wentworth Point. Ideally positioned at the northern tip of the peninsular, Jewel is opposite to the ferry wharf, bus stops and rests above the Pierside retail precinct that includes restaurants, health care, beauty and more.

Apartment features:

- Entertainers gas kitchen with stone/Corian benchtops, soft closing cupboards
- LED lighting, split system reverse cycle air conditioning
- Open living and dining with timber look ceramic tiles
- Lounge room with gas point and MATV and payTV points
- Wool-blend carpeted bedrooms, mirrored built-in robes
- Internal laundry with dryer, audio intercom with security and lift access
- Bathroom/ensuite with ceramic wall and floor tiles, mirrored vanity cabinet
- Basement secure parking with one storage cage.
- On-site building manager

**View**

As advertised or by appointment

**Agent**

**Morton RE**



 rentals@morton.com.au

**morton.com.au**



GOLD SCREEN FACADE

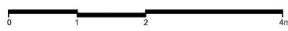

JOINTLY DEVELOPED BY



Disclaimer: This floor plan has been prepared for marketing purposes only. All descriptions, dimensions, depictions and other details in this floor plan may not be to scale and may vary from the property as built. Your attention is drawn to the special conditions of the contract for sale of land. No third party has any authority to make or give any representation or warranty in relation to the property unless the representation or warranty is confirmed by Payce Communities Wentworth Point Pty Ltd and included in the contract for sale of land. SCDA Disclaimer: In this disclaimer, Developer means Payce Communities Wentworth Point Pty Ltd ACN 604 820 744 and SA FWT Development Pty Ltd ACN 164 281 145. Development means the retail and residential development at Burroway Road Wentworth Point known as Jewel. SCDA means Sydney Olympic Park Authority, a statutory body constituted under the Sydney Olympic Park Authority Act 2005 (NSW). The Developer is responsible for all matters in connection with undertaking and completing all of the works required to be performed or carried out to complete the Development and SCDA has no responsibility or involvement in those matters.

SALES BY



(Rev C\_01/06/15 )

# JEWEL

WENTWORTH POINT

## APARTMENT 830

LOT 150  
2BED + STUDY

Internal	80 sqm
External	13 sqm
<b>Total</b>	<b>93 sqm</b>

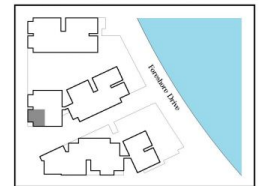

LEVEL 8

**JEWEL DISPLAY CENTRE**  
1 Burroway Road, Wentworth Point 2127  
♦ 1300 888 778 ♦ [jewelresidences.com.au](http://jewelresidences.com.au)