



**morton.**

**Zetland** 308/2 Victoria Park Parade

 1  1  1

Wonderfully positioned in the bustling new precinct in Victoria Park, the 'Stella' apartments provide a new level of living. 'Stella' is superbly designed by Tzannes Associates to maximise light, open spaces and cross-flow ventilation.

- Floating timber floors throughout
- Kitchens include CaesarStone bench tops and Miele appliances
- Polyurethane finish joinery with ample storage
- Bathroom with beautiful Italian fittings
- Feature wall tiles and mirrored storage cabinets
- Video intercom

**View**

As advertised or by appointment

**Agent**

**Sarah Fowell**

 0437 492 129

 sarah@morton.com.au

**morton.com.au**

# STELLA



**#308**  
**1 BED - LEVEL 3** **62 m<sup>2</sup>**



54 sqm internal + 8 sqm balcony

**#310**  
**1 BED - LEVEL 3** **62 m<sup>2</sup>**



54 sqm internal + 8 sqm balcony

**#108**  
**1 BED - LEVEL 1** **62 m<sup>2</sup>**



54 sqm internal + 8 sqm balcony

**#110**  
**1 BED - LEVEL 1** **62 m<sup>2</sup>**

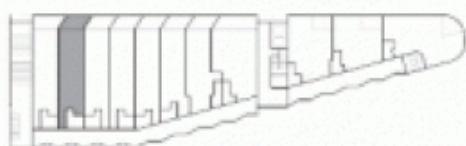

54 sqm internal + 8 sqm balcony

