

# morton.

**Wentworth Point** 464/3 Baywater Drive

 2  2  1

The Waterfront is located moments to Sydney Olympic Park main venues, train station, Bicentennial Park and Millennium Parklands. Located in Palermo, this is your opportunity to move into this two bedroom apartment only a short stroll from The Promenade and The Piazza.

Apartment features:

- North facing located on level four facing the Palermo Courtyard
- Combined living and dining room
- Reverse cycle air conditioning
- Full size kitchen with stainless steel appliances
- Gas cooking and lots of cupboard space
- Great size bedroom with huge built-in wardrobes
- En-suite to both bedrooms
- Two-way bathroom to second bedroom
- Laundry room and clothes dryer
- Secure undercover car space and a storage cage
- Palermo building includes exclusive gym and pool

**View**

As advertised or by appointment

**Agent**

**Morton RE**



 rentals@morton.com.au

[morton.com.au](http://morton.com.au)



- ENTRY 1
- LIVING 2
- DINING 3
- KITCHEN 4
- MAIN BEDROOM 5
- BATHROOM 6
- BEDROOM 2 7
- ENSUITE 8
- LAUNDRY 9
- LINEN 10
- BALCONY 11
- CLOTHES DRYING 12

LEVEL 04

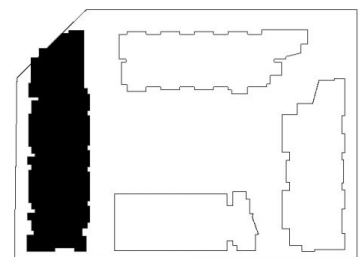

# PALERMO

UNIT: **464**

TYPE: 2 Bedroom

UNIT AREA: 106.0 sqm

OUTDOOR AREA: 23.0 sqm



Disclaimer: All layouts are indicative only, and subject to change.



0 2.5 5M