



# morton.

**Crows Nest** 117/402-420 Pacific Highway



Leased after first open. All future inspections cancelled.

Located in the sought after Atrium building, this newly renovated one bedroom apartment is ideally located within a short stroll to city transport links as well as Willoughby Road's vibrant cafes and eateries.

- Bedroom with mirrored built-in wardrobe
- Modern tiled bathroom with separate tub
- Brand new gas kitchen with ample storage and stainless steel appliances
- Internal laundry
- Security building includes pool, gym, spa and sauna
- Rooftop terrace
- Close to all transport, shops and cafes

### View

As advertised or by appointment

### Agent

**Sarah Fowell**

📞 0437 492 129

✉️ sarah@morton.com.au

[morton.com.au](http://morton.com.au)

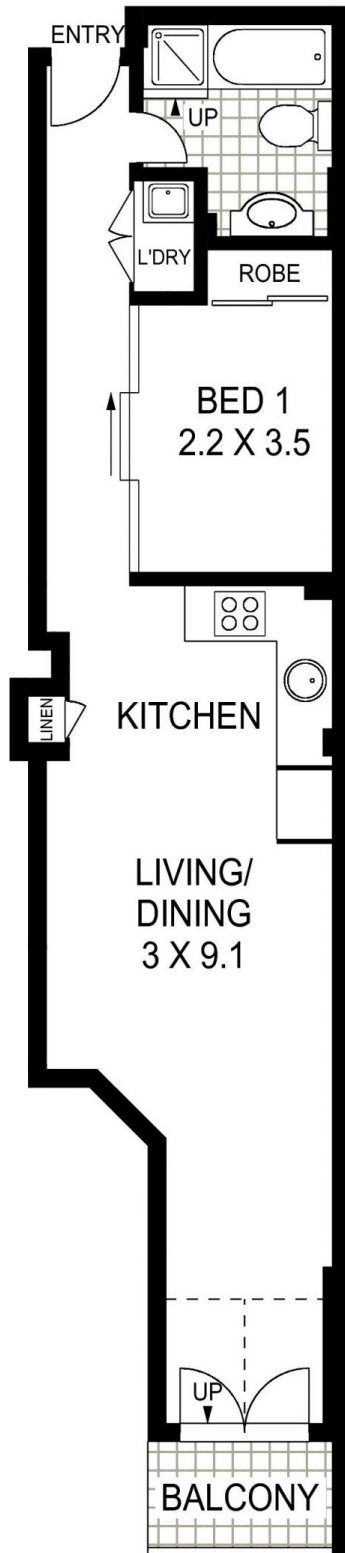

APPROX : GROSS INTERNAL AREA :- 42 SQM



**LEVEL ONE**

**117/ 402-420 PACIFIC HIGHWAY**

**CROWS NEST**

**Floor Plan Disclaimer:** Mind the Gap (mtg) floor plans / site plans are intended as a guide only. No representations or warranties of any nature whatsoever are given or intended and any person using this information should always rely on their own enquiries. mtg property marketing services - 1300 133 145 - photography, floor plans, virtual tours, video tours, copywriting, project marketing - [www.mindthegap.com.au](http://www.mindthegap.com.au)