



**morton.**

**Woolloomooloo** 130/6 Cowper Wharf Roadway

 1  1  1

A unique opportunity to secure a sought after level one terrace apartment at the renowned Finger Wharf at Woolloomooloo. This apartment features a wonderful deck which is great for weekend lunches and evening drinks by the water. Boasting expansive 180 degree water views of Garden Island and Potts Point, could there be a better start and end to the day.

\*\*\* Will also consider without parking for \$750 per week \*\*\*

- Generous sized living area and outdoor terrace
- Wooden floors throughout
- CaesarStone gas kitchen with stainless steel appliances
- Built-in wardrobes and ensuite
- Internal laundry
- Reverse cycle air conditioning
- Secure parking in the building
- 24 hour onsite security

**View**

As advertised or by appointment

**Agent**

**Sarah Fowell**



 sarah@morton.com.au

**morton.com.au**

**130/6 Cowper Wharf Road,  
WOOLLOOMOOLOO**

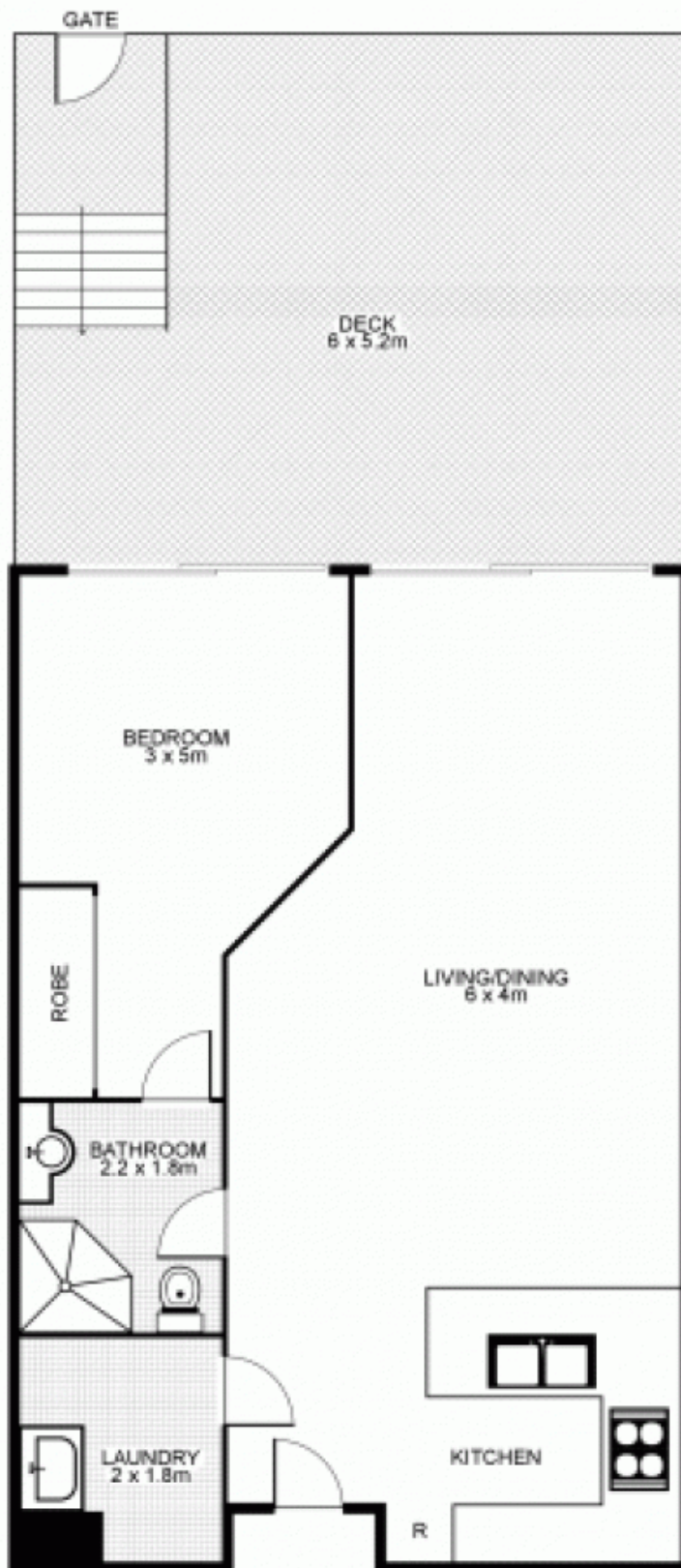

Plans by  
**surroundpix**  
com.au  
1300 30 32 40

This floor plan is intended as a guide only. Layout dimensions are approximate only. No representation or warranties of any nature whatsoever are given or intended. Any person using this information should rely on their own enquiries.