



morton.

Mosman 4/27 Bradleys Head Road

 3  1  1

Deposit taken. All future inspections cancelled.

Rent reduced for short term lease. 6 months only

Located in a well maintained Art Deco security block of 4 apartments and boasting an enviable address surrounded by some of Sydney's grandest homes, this private top floor residence is certainly a fantastic lifestyle opportunity. Direct access to bus and ferry transport and perfectly located within close proximity of Mosman Village, Clifton Gardens and Bradley's Head waterfront tracks, this home offers an opportunity to enjoy a lifestyle unique to this exclusive peninsula.

- Substantial well proportioned apartment
- High ceilings and character features
- Spacious study/Sun-room
- Separate dining room with harbour views
- Common area includes a rear lawn & garden
- Walk to Taronga Zoo ferry for city transport

morton.com.au

View

As advertised or by appointment

Agent

Sarah Fowell

 0437 492 129

 sarah@morton.com.au

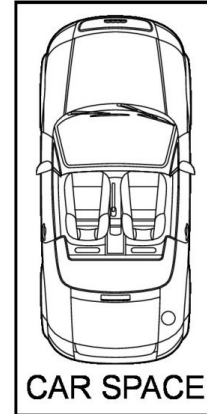
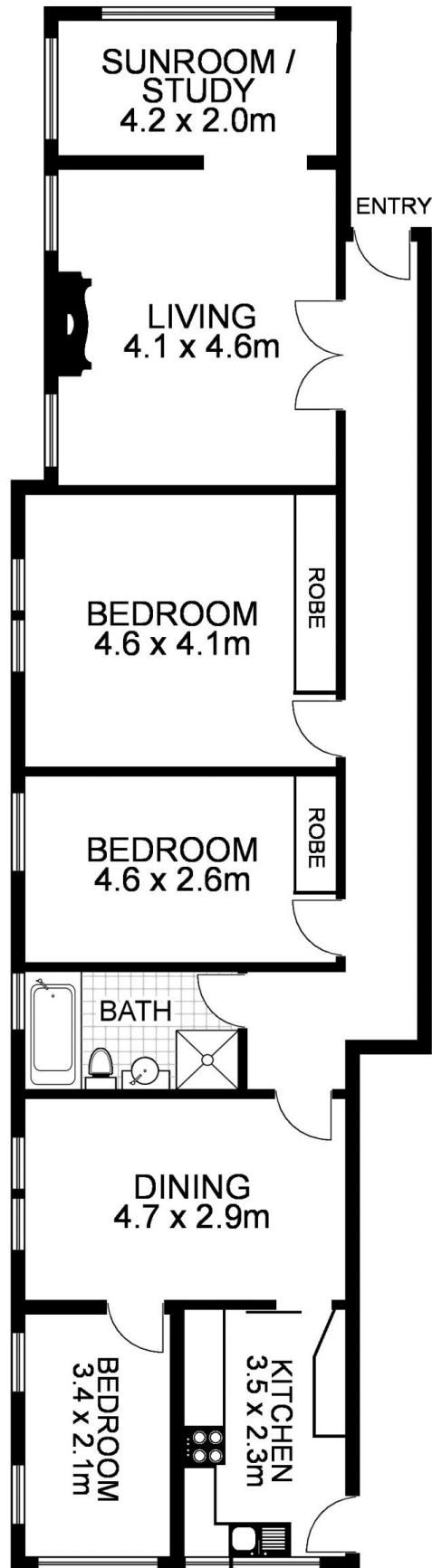

INTERNAL AREA : 120 m²
 CAR SPACE : 16 m²
 TOTAL AREA : 136 m²



4/27 Bradleys Head Road, MOSMAN

Disclaimer: This floor plan is intended as a guide only. Layout dimensions are approximate only. No representations or warranties of any nature whatsoever are given or intended. Any individuals using this information should always rely on their own enquiries.

www.alchemyimaging.com.au