



morton.

Wentworth Point 302/4 Nuvolari Place

 1  1  1

Flooded with natural light and opening to an expansive courtyard, this superb residence is peacefully set in the heart of exclusive Wentworth Point. Designed for a low maintenance contemporary lifestyle of convenience and distinction, it is approximately a ten minute walk to Rhodes Station.



- Impeccably presented interiors, quality appointments
- Combined lounge and dining flows to a huge courtyard
- Stylish kitchen, CaesarStone benches, gas appliances
- Generous master bedroom with built-in robe
- Stunning communal gardens, facilities include pool, gym
- Air conditioning and video intercom and storage cage

View



As advertised or by appointment

Agents

Sarah Fowell

 0437 492 129
 rentals@morton.com.au

Dylan Choe

 0416 932 977
 dylanchoe@morton.com.au

morton.com.au

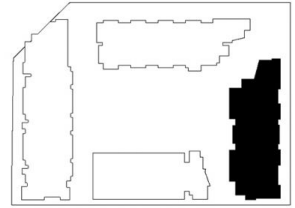

PALERMO

UNIT: **302**

TYPE: **1 Bedroom**

UNIT AREA: **54.0 sqm**

OUTDOOR AREA: **29.0 sqm**



0 2.5 5M