



# morton.

**Penrith** 510/60 Lord Sheffield Circuit



**LEASED for \$410 pw!**

If you are a property owner looking for a tenant, please contact David Lipman 0409 663 535, [david@morton.com.au](mailto:david@morton.com.au), so we can introduce more tenants to your property.

Wildwood Apartments within Sheffield Quarter is a brand new apartment development located on the north side of Penrith train station situated in the highly sought-after master-planned community Thornton Estate. With uninterrupted park and district views, plus water views towards the picturesque Blue Mountains, offering convenient apartment living only metres to Penrith train station, Westfield shopping centre, local parks and quality restaurants and cafes.

- One bed plus study unfurnished brand new top floor apartment positioned on the north east side of the building with district views from the north facing balcony. The common rooftop BBQ area on level 6 enjoys views of the water canal, cricket oval and the picturesque Blue Mountains, providing some of the best views you will find in Thornton.

### View

As advertised or by appointment

### Agent

**David Lipman**

📞 0409 663 535

✉ [david@morton.com.au](mailto:david@morton.com.au)

[morton.com.au](http://morton.com.au)



**SHEFFIELD QUARTER**

THORNTON

ONE BEDROOM + STUDY  
APARTMENT

UNIT 2.10 LOT 32  
UNIT 3.10 LOT 47  
UNIT 4.10 LOT 62  
UNIT 5.10 LOT 77

INTERNAL AREA: 56 m<sup>2</sup>  
EXTERNAL AREA: 8 m<sup>2</sup>

TOTAL: 64 m<sup>2</sup>

PARKING: 1

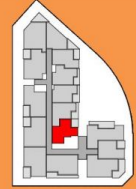

URBAN CBRE



All apartments subject to contract and availability. Images showing the building, interiors and views are computer generated prior to construction and indicative only. Dimensions, layout, finishes and specifications are subject to change and may differ from those shown. Views differ between apartments. Ground floor retail not yet confirmed. Furniture and plantings are for decorative purposes and are not included.