



morton.

Wentworth Point 114/3 Amalfi Drive

 2  2  1

Well kept two bedroom apartment, located close to The Promenade with great waterviews from a covered entertainers balcony. Features include:

- Open plan living and dining area
- Main bedroom with waterviews + ensuite
- Large entertainers balcony
- Split system air conditioning in living area
- Built-in wardrobes
- Full size kitchen
- Gas cooking + stainless steel appliances
- Internal laundry with dryer
- Internal storage
- One car space
- Access to outdoor pool

View

As advertised or by appointment

Agent

Morton RE



 rentals@morton.com.au

morton.com.au

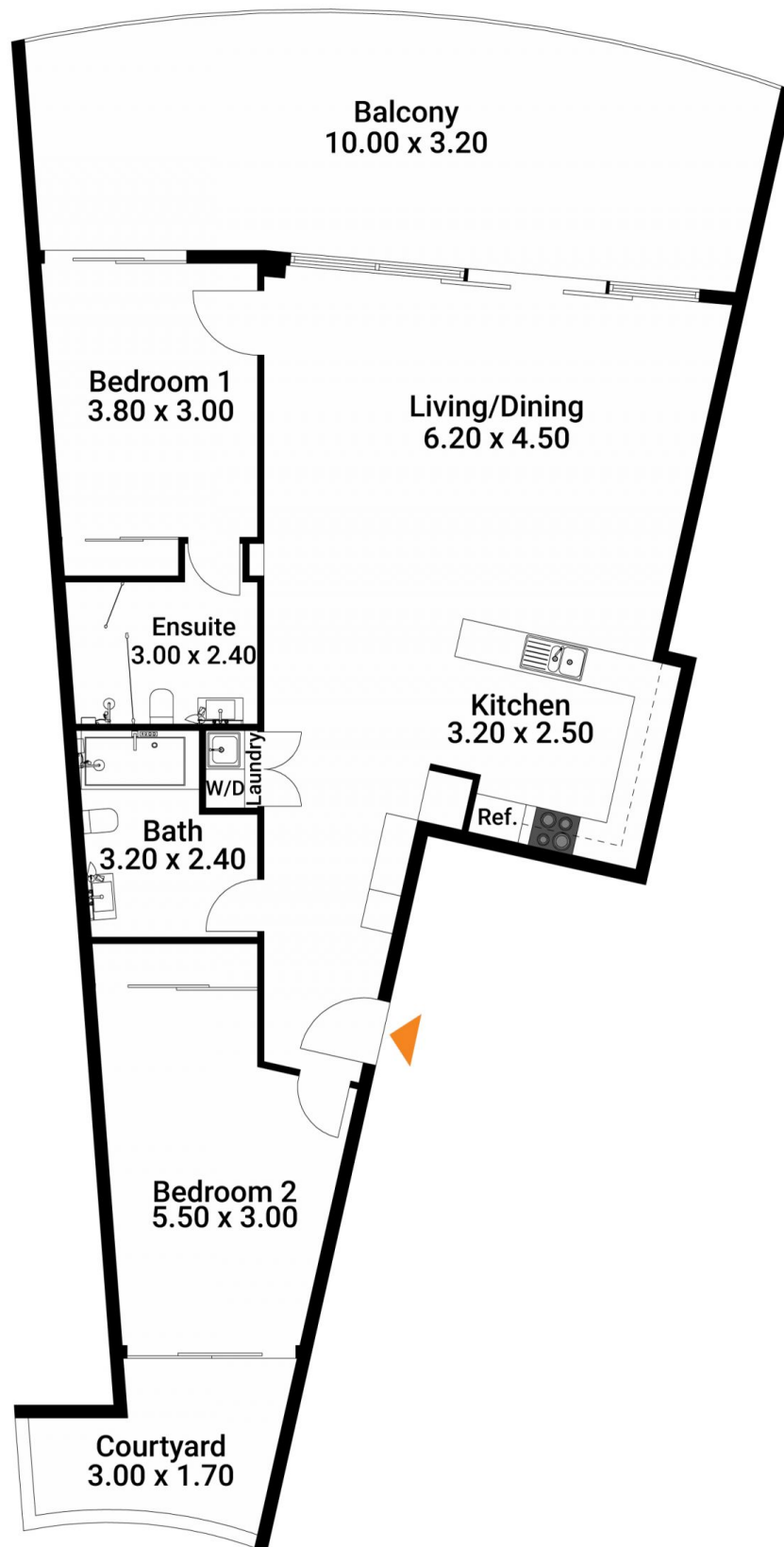

The floor plan is not to scale. Measurements are indicative and in metres.

Produced by DIAKRIT



The interior style and design of this floor plan is designed for inspiration purposes to show the living spaces. It is not an exact replica of the furniture and fittings in the home.

Produced by DIAKRIT