



**morton.**

**Penrith** 303/81B Lord Sheffield Circuit

 2  2  1

Thornton Central apartments located on the north side of Penrith train station with park and district views, some with water views towards the picturesque Blue Mountains, situated in the master-planned community Thornton Estate, offering convenient apartment living only metres to Westfield shopping centre, local parks and quality restaurants and cafes.

#### Features

- Lv 3, Northeast facing, covered balcony with garden views
- Reverse cycle A/C in living and bed, block-out roller blinds throughout
- Main bedroom with walk-in robes, ensuite and access to main balcony
- Second bedroom has smart access to main bathroom, private balcony
- Timbered open living and dining area, efficient LED lighting throughout
- Filled with natural light from the floor to ceiling windows
- Eat-in kitchen with stone bench-tops, soft close cupboards
- Four burner stove top with stainless steel appliances

**morton.com.au**

#### View

As advertised or by appointment

#### Agent

**David Lipman**

 0409 663 535

 david@morton.com.au

*Apartment*

2 BED - B 303

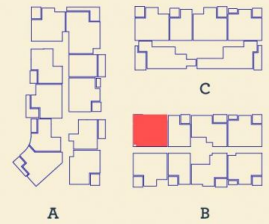

Internal	76 m <sup>2</sup>
External	8 m <sup>2</sup>
<b>Total</b>	<b>84 m<sup>2</sup></b>

DATE ISSUED 27/07/2015  
VERSION 02

Developed by **St Hilliers** **FIRST POINT PROJECTS** | Sales by **LINK** **Home LandDirect** [thorntoncentral.com.au](http://thorntoncentral.com.au)

**Disclaimer:** This floor plan has been prepared for marketing purposes only. All descriptions, dimensions, depictions and other details in this floor plan together, the "Information" may not be to scale. The vendor reserves the right to vary or amend the Information without notice. The Information may vary from the actual dimensions, layout and characteristics of the property as built. No third party has any authority whatsoever, either expressly or impliedly, to make or give any representation or warranty or to bind the vendor in connection with the information or the property.

**THORNTON**