



morton.

Wentworth Point 928/1 Burroway Road

 2  2  1

Jewel the new and iconic gateway that connects the Sydney Harbour to Wentworth Point. Ideally positioned at the northern tip of the peninsular, Jewel is opposite to the ferry wharf, bus stops and rests above the Pierside retail precinct that includes restaurants, health care, beauty and an IGA supermarket.

- Entertainers gas kitchen with stone/Corian benchtops, soft closing cupboards
- LED lighting, split system reverse cycle air conditioning
- Open living and dining with timber look ceramic tiles
- Lounge room with gas point and MATV and payTV points
- Wool-blend carpeted bedrooms, mirrored built-in robes
- Internal laundry with dryer, audio intercom with security and lift access
- Bathroom/ensuite with ceramic wall and floor tiles, mirrored vanity cabinet
- Large covered balcony with gas point for BBQ
- Basement secure parking, some with a storage cage
- On-site building manager, common landscaped courtyard

View

As advertised or by appointment

Agent

Morton RE



 rentals@morton.com.au

morton.com.au



JEWEL
WENTWORTH POINT

APARTMENT
928
LOT 158
2BED + STUDY

Internal	80 sqm
External	15 sqm
Total	95 sqm

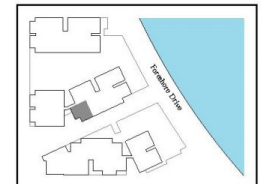

LEVEL 9

JEWEL DISPLAY CENTRE
1 Burroway Road, Wentworth Point 2127
1300 888 778 • jewelresidences.com.au

JOINTLY DEVELOPED BY



Disclaimer: This floor plan has been prepared for marketing purposes only. All descriptions, dimensions, depictions and other details in this floor plan may not be to scale and may vary from the property as built. Your attention is drawn to the special conditions of the contract for sale of land. No third party has any authority to make or give any representation or warranty in relation to the property unless the representation or warranty is authorised by Payce Communications Wentworth Point Pty Ltd. (PCW) Development Pty Ltd and included in the contract for sale of land. 5/2018 Disclaimer: In this disclaimer, Developer means Payce Communications Wentworth Point Pty Ltd ACN 161 430 746 and SH Development Pty Ltd ACN 164 28 145. Development means the retail and residential development at Burroway Road, Wentworth Point known as Jewel. 5/2018 means Sydney Olympic Park Authority, a statutory body constituted under the Sydney Olympic Park Authority Act 2007 (NSW). The Developer is responsible for all matters in connection with understanding and completing all of the works required to be performed or carried out to complete the Development and 5/2018 has no responsibility or involvement in those matters.

SALES BY



(Rev C_01/06/15)