



morton.

Wentworth Point 73/27 Bennelong Parkway



Privately situated in the highly prized Mariners Cove, this corner positioned apartment benefits from an abundance of natural light while offering ample opportunities to upgrade and renovate.

- Lounge room with great aspects
- Two balconies, north-west and south-west facing
- Kitchen with original fittings
- Bedroom with direct balcony access
- Resort style facilities including gym, steam room and man-made beach

In the heart what is considered to be one of Sydney's premier harbourside communities, this apartment is ideally set just moments to village cafes and shops. Ferry services, Rhodes station/shopping facilities and the Olympic Park are easily accessible.

Outgoings:
Water Rates: \$178 p/q approx.

morton.com.au

View

As advertised or by appointment

Agent

Sarah Fowell

📞 0437 492 129

✉️ rentals@morton.com.au



DISCLAIMER

NO RESPONSIBILITY TAKEN FOR INFORMATION PROVIDED HEREIN.
 INTERESTED PARTIES SHOULD RELY ON THEIR OWN ENQUIRIES
 AND THE CONTRACT FOR SALE. CARPARK AREAS NOT INCLUDED,
 REFER TO STRATA PLANS FOR ADDITIONAL INFORMATION.

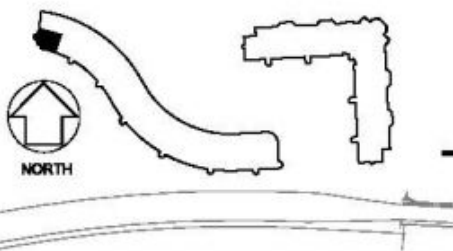

APARTMENT 73

1 BEDROOM

INTERNAL AREA 48 sqm
 EXTERNAL AREA 12 sqm
 TOTAL AREA 60 sqm

MARINERS COVE

RESIDENTIAL APARTMENTS

27 Bennelong Road
 Homebush Bay