



morton.

Wentworth Point 716/37 Amalfi Drive

 1  1  1

Filled with natural light this well designed apartment offers expansive North and Westerly aspects along with water glimpses from the spacious balcony. Recently rented for \$450 p/w the unit represents a great opportunity for both investors and first time buyers alike.

- Open plan lounge/dining area with direct balcony access
- Fully fitted kitchen with stainless steel appliances
- Tiled bathroom with bath tub and internal laundry with dryer
- Split system air-conditioning unit and audio/visual security intercom
- Single parking with storage cage and separate 9 sqm storage room
- Bus services on your door step offering easy access to transport and shopping facilities at Rhodes via new Bennelong Bridge
- Close to The Piazza and Newington Shopping Village with an array of cafes and restaurants at your disposal

View

As advertised or by appointment

Agent

Sarah Fowell

 0437 492 129

 rentals@morton.com.au

morton.com.au

716/37 Amalfi Drive, Wentworth Point

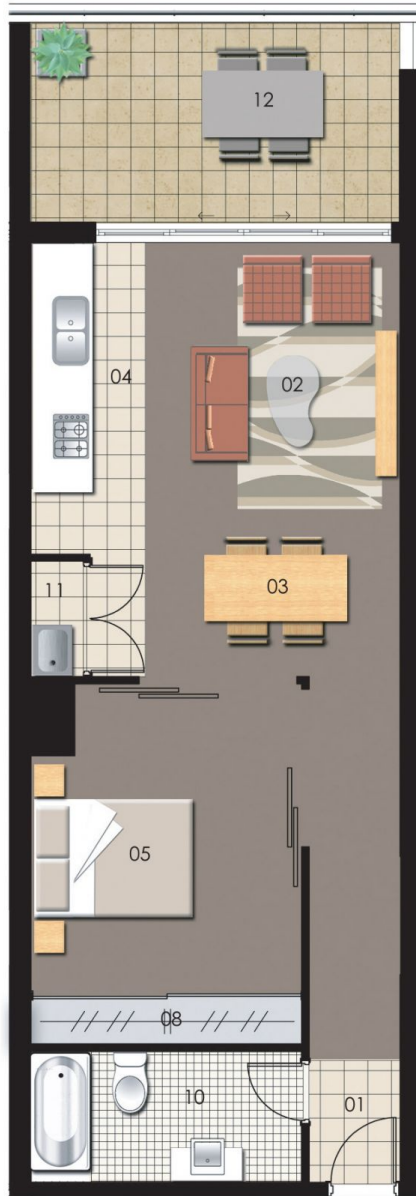

ENTRY	01	WARDROBE	08
LIVING	02	ENSUITE	09
DINING	03	BATHROOM	10
KITCHEN	04	LAUNDRY	11
BEDROOM 1	05	BALCONY	12
BEDROOM 2	06	STORAGE	13
BEDROOM 3	07		



Unit 716

Lot Number	11
Type	1 Bedroom
Unit Area	56 sqm
Balcony	9 sqm
Total	65 sqm