



**morton.**

**Pyrmont** 238 Harris Street

 2  1

A historic turn-of-the-century Victorian terrace in an ultra convenient community setting, this classic home presents a truly remarkable opportunity. Flowing over two levels and presented to the market for the first time in 32 years, there is vast potential to completely refurbish throughout.

- Opening to the light of a rear eastern perspective
- Separate yet adjoining lounge and dining spaces
- Sunny rear courtyard, study/tv room and a sunroom
- Room to reconfigure and maximise the floorplan, STCA
- Large electric kitchen, high ceilings, front/rear court yard
- Potential to create a sophisticated contemporary home

#### **View**



As advertised or by appointment

#### **Agents**

##### **Ian Qiu**

 0447 696 425  
 [ian@morton.com.au](mailto:ian@morton.com.au)

##### **Natasha Giannone**

 0438 683 859  
 [natasha@morton.com.au](mailto:natasha@morton.com.au)

[morton.com.au](http://morton.com.au)

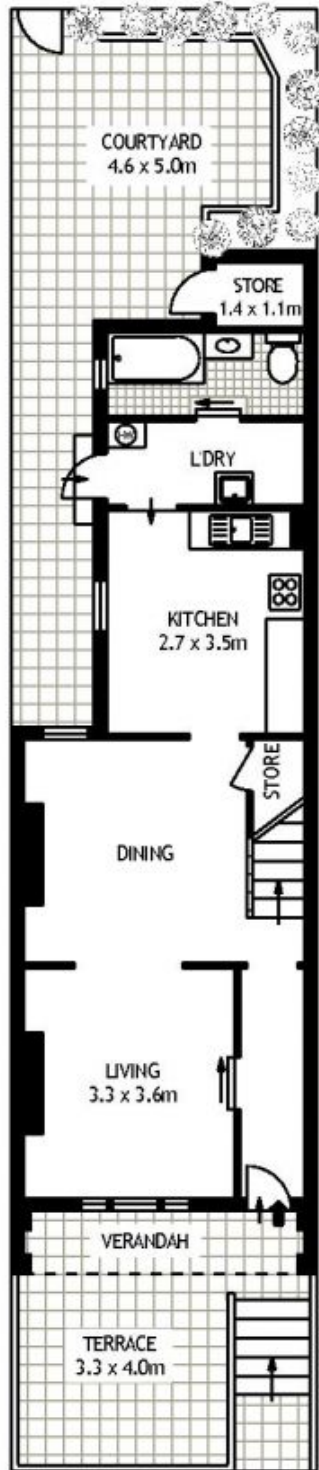

GROUND FLOOR



FIRST FLOOR



238 HARRIS STREET

PYRMONT

SCAPE Floor Planning Disclaimers: This floor plan is conceptual only. It is provided for illustrative purposes only and should not be relied upon. We make no guarantees to the correctness of this plan. All interested parties should make and rely on their own enquiries in determining the accuracy of the information contained in this floor plan.