



# morton.

**Wentworth Point** 147/27 Bennelong Parkway

 2  2  1

Well positioned in the Spinnaker building of the Mariners Cove complex this generous two bedroom 5th floor apartment is complimented by an abundance of natural light due to the North facing orientation. With water views and access to the outdoor area from all rooms.

- Luxury apartment located on level 5
- Air conditioning in bedroom and lounge room
- Open plan living area
- 28sqm deck with great water views
- Direct access to pool with man made beach
- Generous bedroom space
- Built-in-robos to bedrooms
- Security single car park

### View

As advertised or by appointment

### Agent

**Morton RE**



 [rentals@morton.com.au](mailto:rentals@morton.com.au)

[morton.com.au](http://morton.com.au)



**DISCLAIMER**  
 NO RESPONSIBILITY TAKEN FOR INFORMATION PROVIDED HEREIN.  
 INTERESTED PARTIES SHOULD RELY ON THEIR OWN ENQUIRIES  
 AND THE CONTRACT FOR SALE. CARPARK AREAS NOT INCLUDED.  
 REFER TO STRATA PLANS FOR ADDITIONAL INFORMATION.

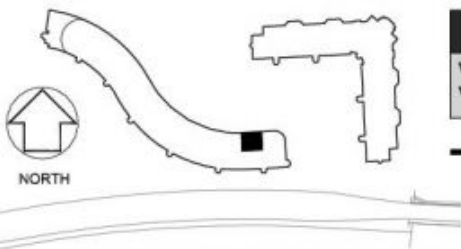

**APARTMENT 147**

2 BEDROOM

INTERNAL AREA 74 sqm  
 EXTERNAL AREA 28 sqm  
 TOTAL AREA 102 sqm

# MARINERS COVE

RESIDENTIAL APARTMENTS

27 Bennelong Road  
 Homebush Bay