



morton.

Riverwood 510/1 Vermont Crescent

 2  2  1

Located in the new urban hub of Washington Park with easy access to the M5 and only 20 kms to the CBD.

- Reverse cycle air conditioning
- Stainless steel kitchen appliances
- Two bedrooms
- Two bathrooms

View

As advertised or by appointment

Agent

Morton

 [info@morton.com.au](tel:)

morton.com.au



**APARTMENT 510
LOT 77
2BED + STUDY**

Internal	77m ²
External	11m ²
Total	88m²

FAIRMOUNT

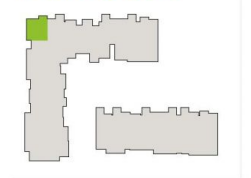

1300 111 088
www.washingtonpark.com.au



Disclaimer: This floor plan has been prepared for marketing purposes only. All descriptions, dimensions, depictions and other details in this floor plan may not be to scale and may vary from the property as built. Your attention is drawn to the special conditions of the contract for sale of land. No third party has any authority to make or give any representation or warranty in relation to the property unless the representation or warranty is confirmed by Payce Communities No.2 Pty Limited and included in the contract for sale of land. [Rev A, 24.07.13]

